

CUSTOMER APPROVAL
 PRINT NAME
 SIGNATURE

FARBER
SPECIALTY VEHICLES
 7052 AMERICANA PARKWAY
 COLUMBUS, OH 43068
 USA

REVISION HISTORY		NO.	DESCRIPTION	BY	DATE

REV	DATE	DESCRIPTION
1	1-14-16	DESIGN CHANGE

UNLESS OTHERWISE SPECIFIED:
 DIMENSIONS ARE IN INCHES
 FINISHES ARE AS SHOWN
 DIMENSIONS ARE TO FACE UNLESS NOTED OTHERWISE
 DIMENSIONS ARE TO CENTER UNLESS NOTED OTHERWISE
 DIMENSIONS ARE TO CENTER UNLESS NOTED OTHERWISE
 DIMENSIONS ARE TO CENTER UNLESS NOTED OTHERWISE

DESIGNER	BCN - BH	DATE	1-14-16
ENGINEER	G. CAIN		
APPROVAL			
CUSTOMER	FSV BODY 16'		
TITLE	US COMMUNITIES		
SCALE	1:24	NO.	15588
REV	D	DATE	S.1

MODEL: FSV BODY 18 MOBILE DENTAL VEHICLE

Body 18', 27' overall length, 6.7L diesel powered, 19,500 GVWR, 40 gallon fuel tank, 102" exterior width, aluminum/galvanized steel body construction. Class "A" fire rated fiberglass interior wall and ceiling finish, commercial vinyl flooring. Roof air conditioner, electric heat, magnetic/hydraulic 12V circuit breakers, electronic master disconnect switches for main and auxiliary battery system, 36' shoreline. Custom cabinets cut using CNC router.

Space is designed for efficiency and ergonomic function for an optimized workflow. Floorplan includes one operatory, intake/reception area, waiting area and sterilization area. Custom options for restroom, ADA accessibility, testing equipment, additional entrances and awnings. Alternative length options available. 4-wheel drive option available. See price sheet for details.



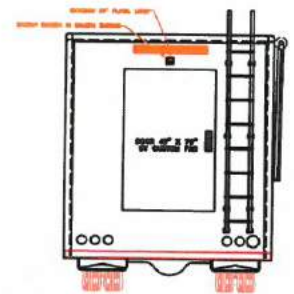
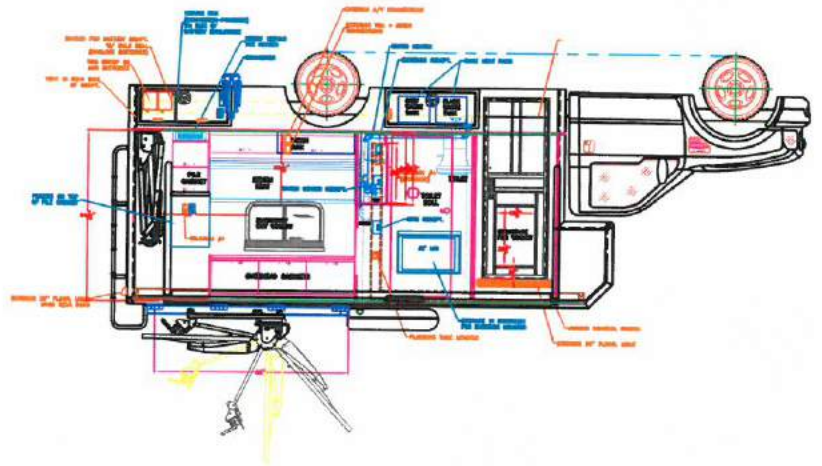
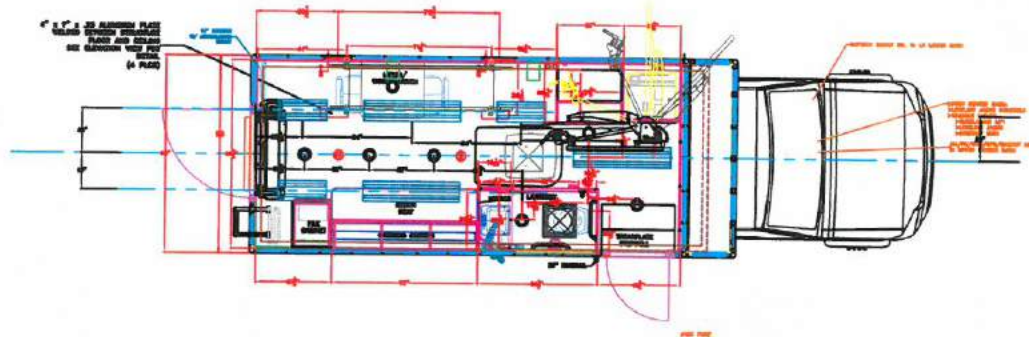
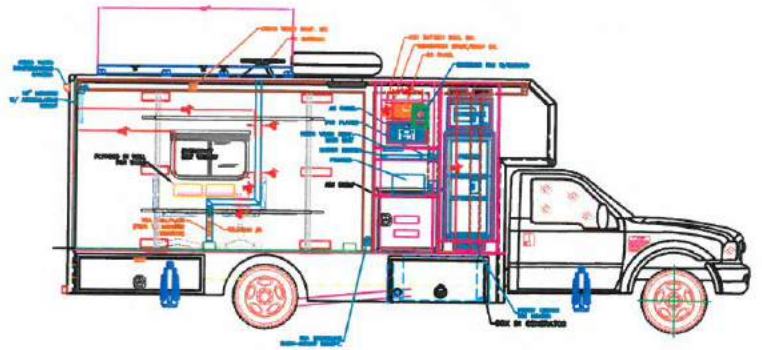

CUSTOMER APPROVAL
 PRINT NAME
 SIGNATURE DATE

FARBER
 SPECIALTY VEHICLES
 7852 AMERICANA PARKWAY
 COLUMBUS, OH 43068
 USA

**MODEL: FSV BODY 18
COMMAND - CSI - EVIDENCE COLLECTION**

Body 18'27" overall length, 6.84L Triton E.F.I. V-10 powered, 19,500 GVWR, 40 gallon fuel tank, 102" exterior width, aluminum/galvanized steel body construction. Class "A" fire rated fiberglass interior wall and ceiling finish, commercial floor finish. Roof air conditioner, electric heat, magnetic/hydraulic 12V and 120V circuit breakers, electronic master disconnect switches for main and auxiliary battery system, 36' shoreline. Custom cabinets cut using CNC router. 4-wheel drive and diesel options available.



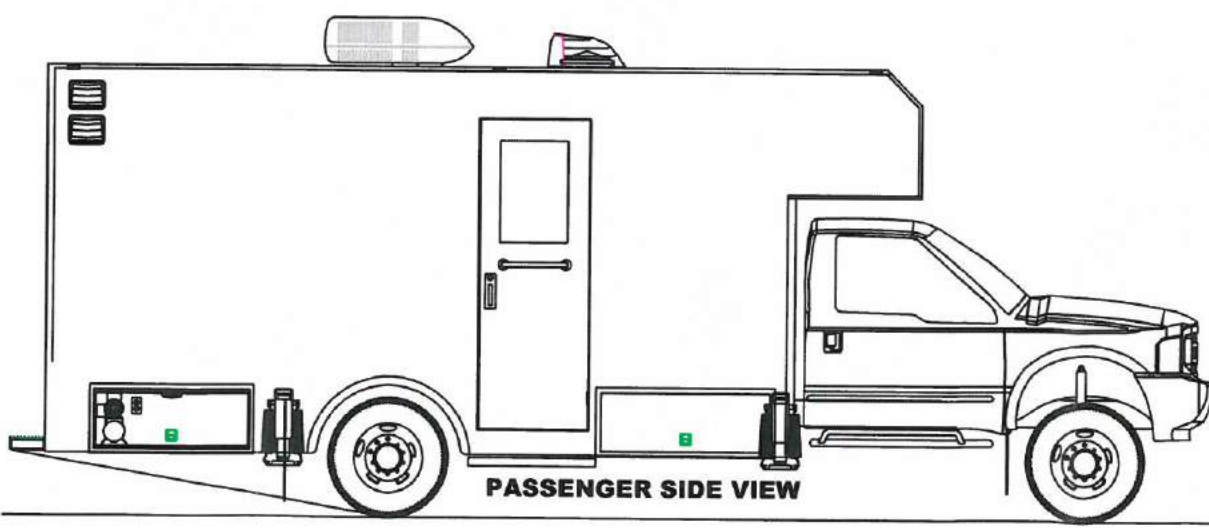
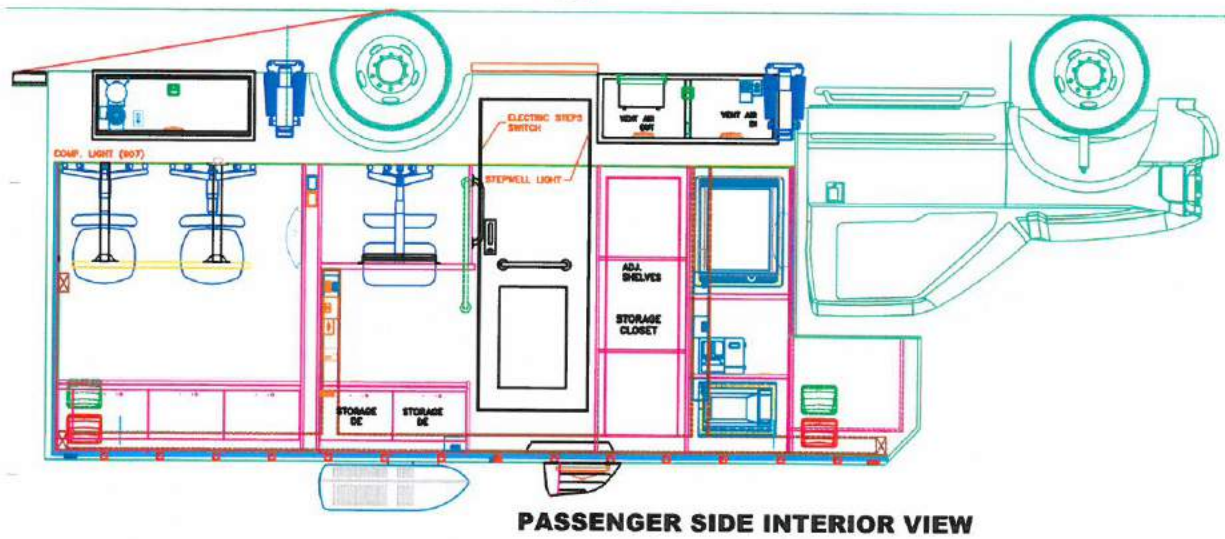
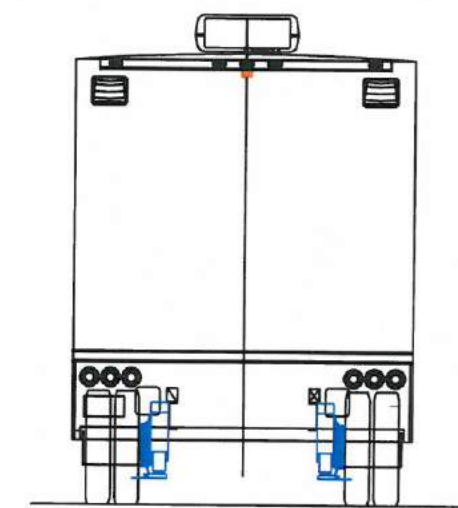
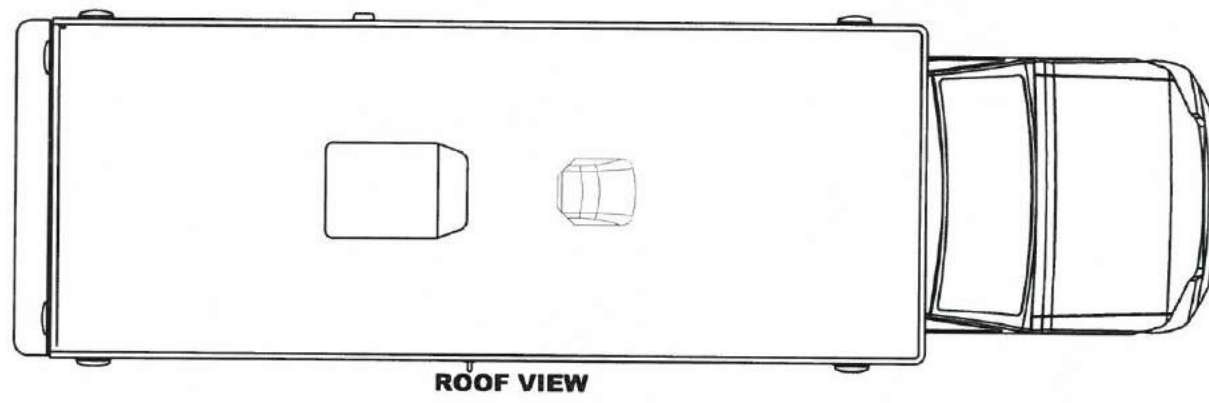
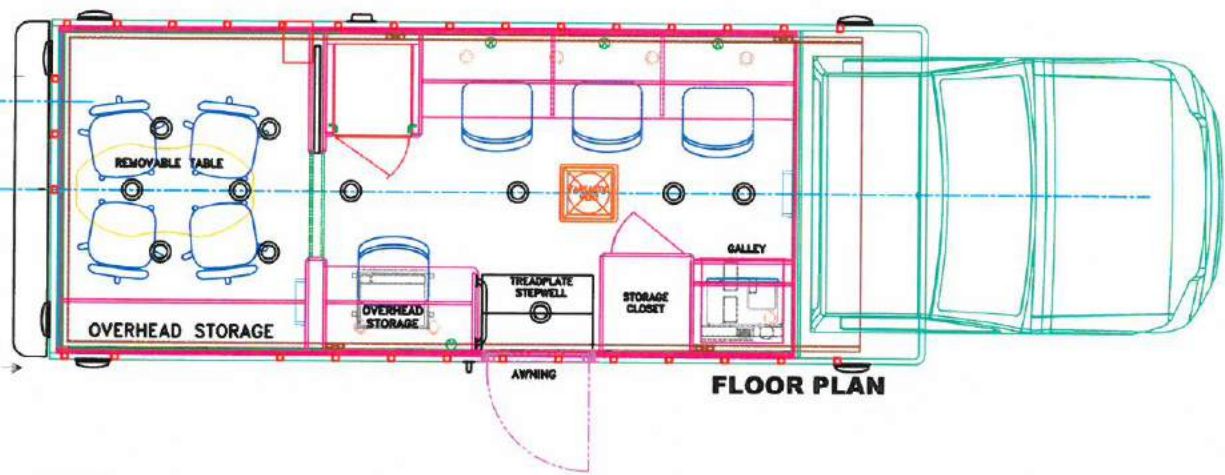
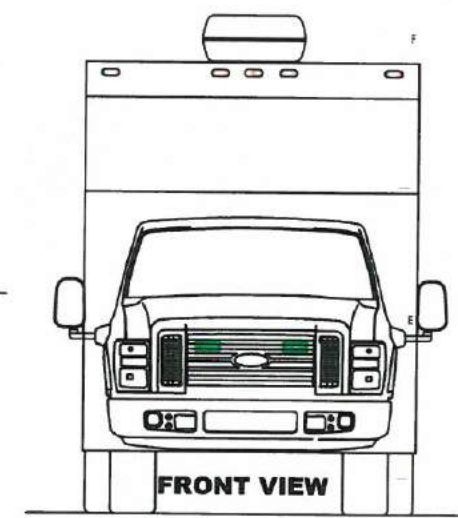
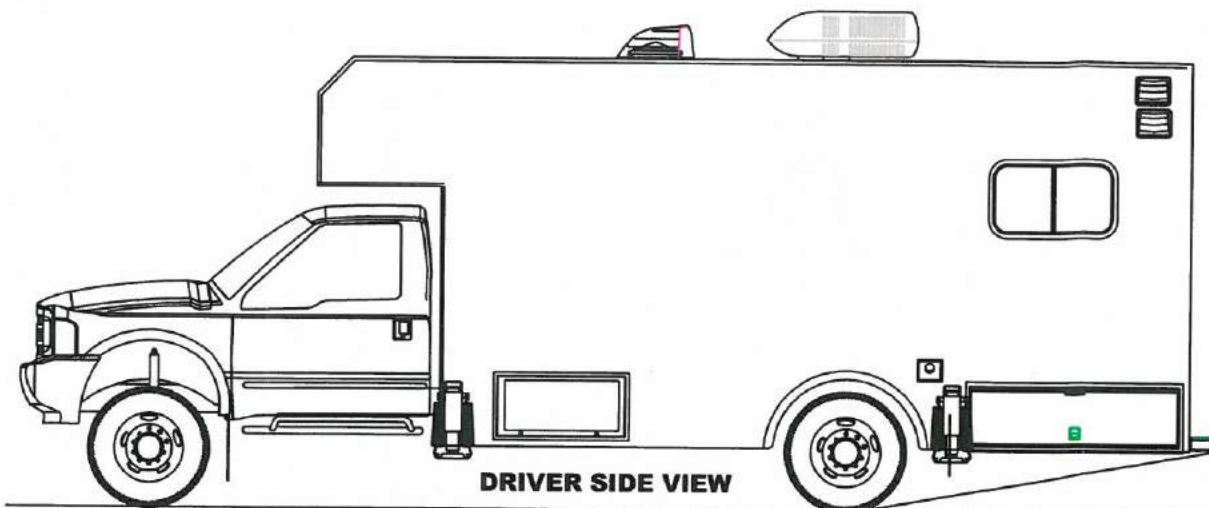
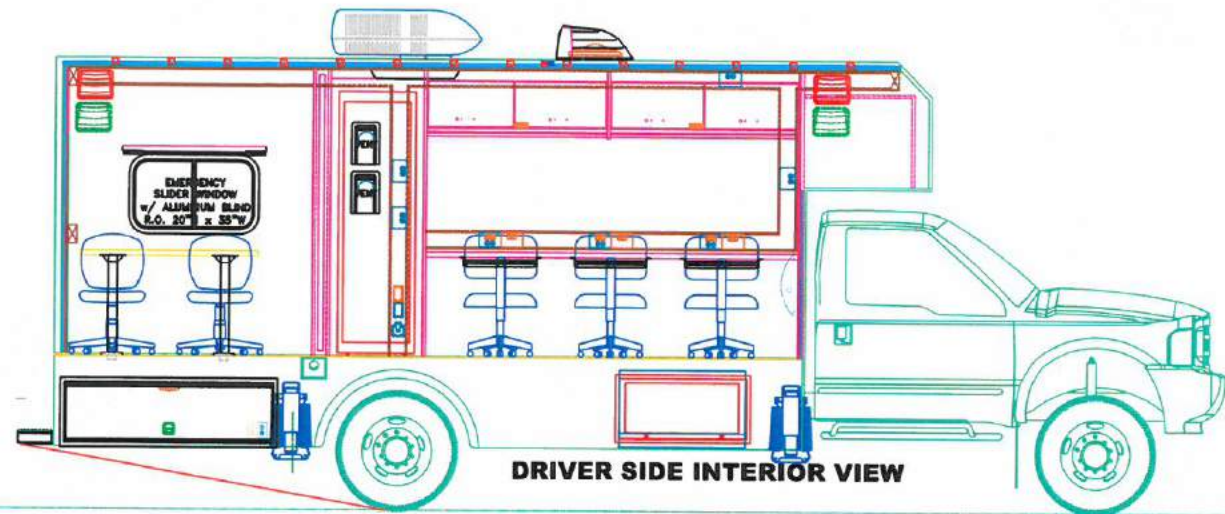

CUSTOMER APPROVAL
 PRINT NAME
 SIGNATURE
 DATE

FARBER
 SPECIALTY VEHICLES
 7952 AMERICANA PARKWAY
 COLUMBUS, OH 43068
 USA

REVISION HISTORY		ENGINEER	DATE
REV.	DESCRIPTION		

BODY	DESIGN ENGINEER	B. HARLAN	1-14-16
CHASSIS	ELEC. ENGINEER		
	ENG. MGR. APPROVAL		
	SALES		
UNLESS OTHERWISE SPECIFIED: DIMENSIONS ARE IN INCHES TOLERANCES: FRACTIONAL: ± 1/16 ANGULAR: BEND ± 5° TWO PLACE DECIMAL ± .04 THREE PLACE DECIMAL ± .004			
PROPRIETARY AND CONFIDENTIAL THE INFORMATION CONTAINED IN THIS DRAWING IS THE SOLE PROPERTY OF FARBER SPECIALTY VEHICLE. ANY REPRODUCTION IN PART OR AS A WHOLE WITHOUT THE WRITTEN PERMISSION OF FARBER SPECIALTY VEHICLE IS PROHIBITED.			

CUSTOMER	FSV BODY 18'		
TITLE	US COMMUNITIES		
SHEET SIZE	SCALE	UNIT NO.	REV
D	1:24	16006	

**MODEL: FSV BODY 20
MOBILE MEDICAL HEALTH VEHICLE**

20'Box, 29' overall length, 260 hp diesel engine, 26,000 GVWR, Allison 2500 RDS automatic 5 speed, 60 gallon fuel tank, two air conditioners. Magnetic/hydraulic 12V circuit breakers, electronic master disconnect switches for main and auxiliary battery system, 36' shoreline. Commercial /medical grade vinyl flooring. Electric heat, automatic computerized hydraulic leveling/stabilizing system, magnetic/hydraulic 12V circuit breakers, electronic master disconnect switches for main and auxiliary battery system, 90 amp. converter, 36' shoreline. Custom cabinets cut using CNC router.

Space is designed for efficiency and ergonomic function for an optimized workflow. Floorplan includes one or two exam rooms, intake/reception area, waiting area and lab area. Custom options for restroom, ADA accessibility, testing equipment, additional entrances and awnings. See price sheet for details. Alternative length options available.



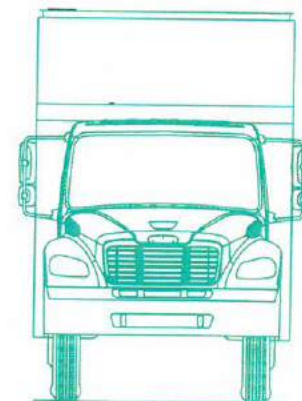
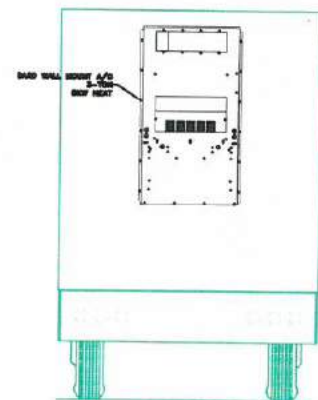
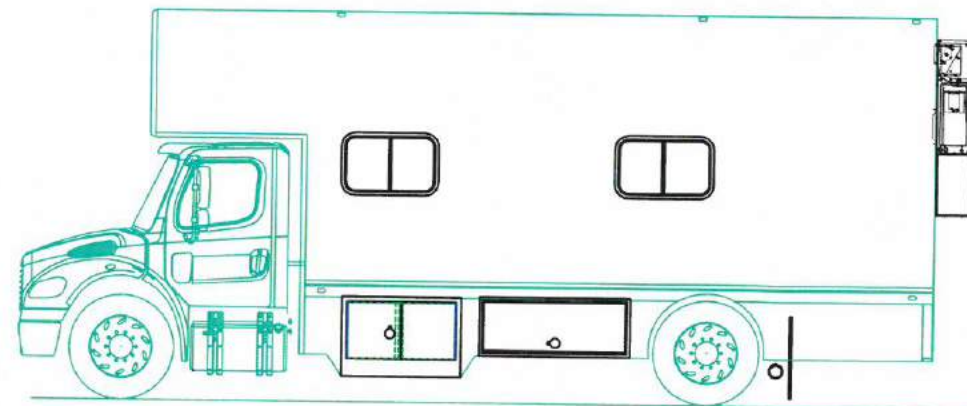
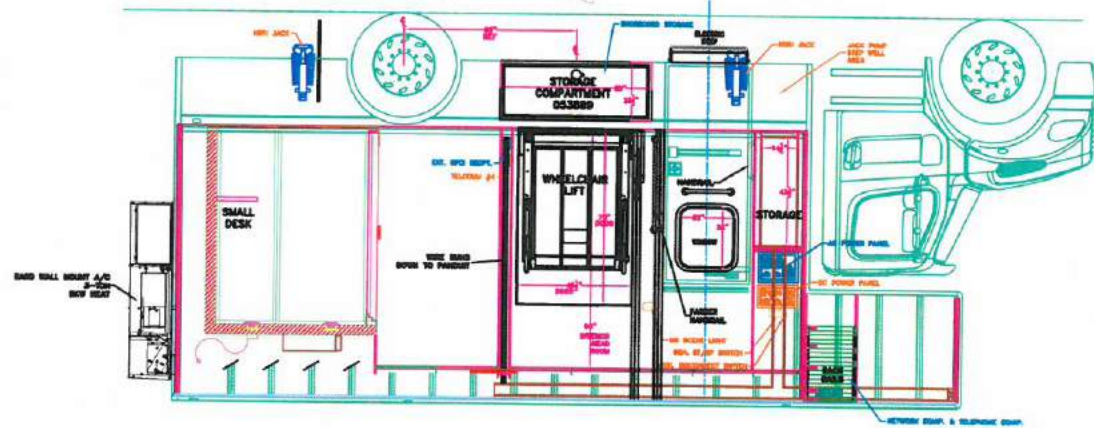
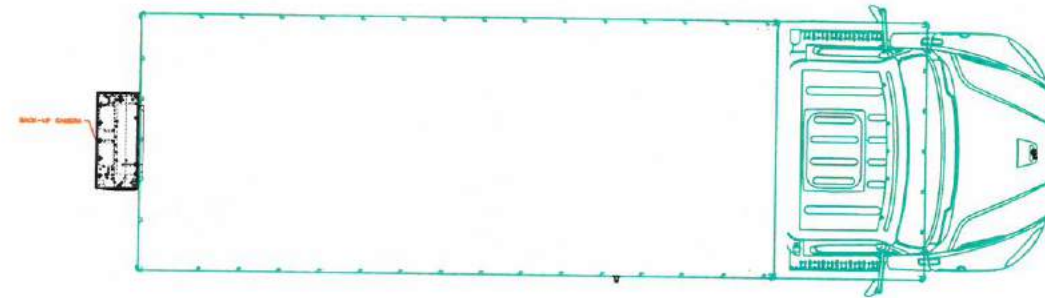
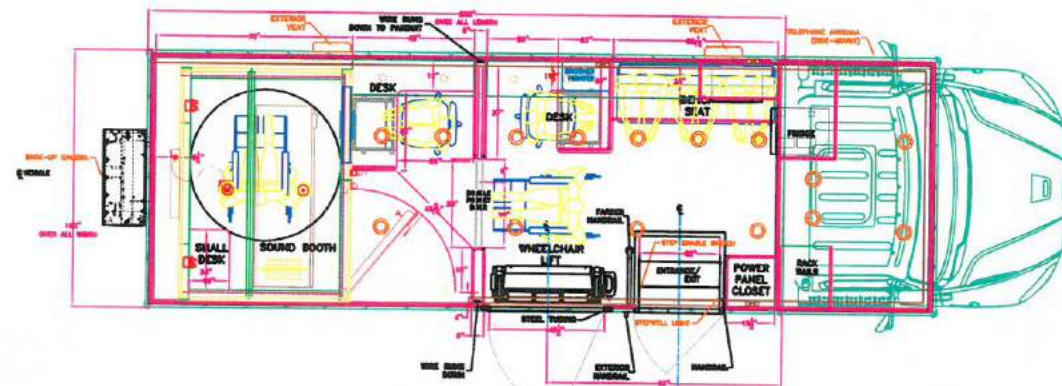
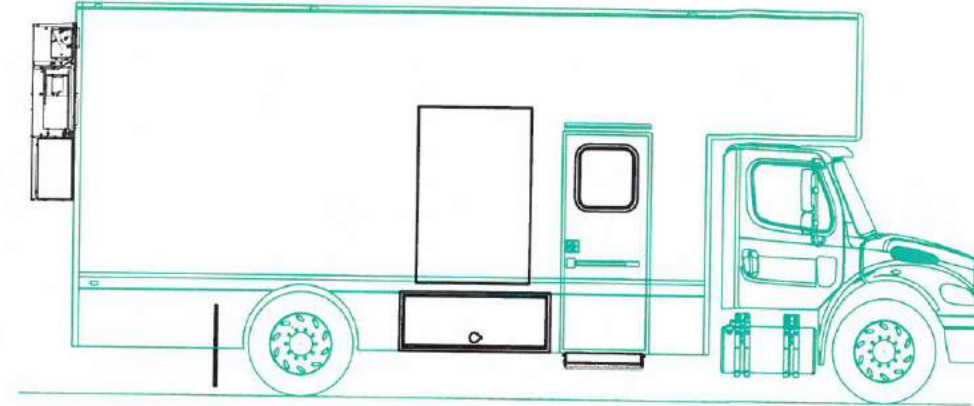
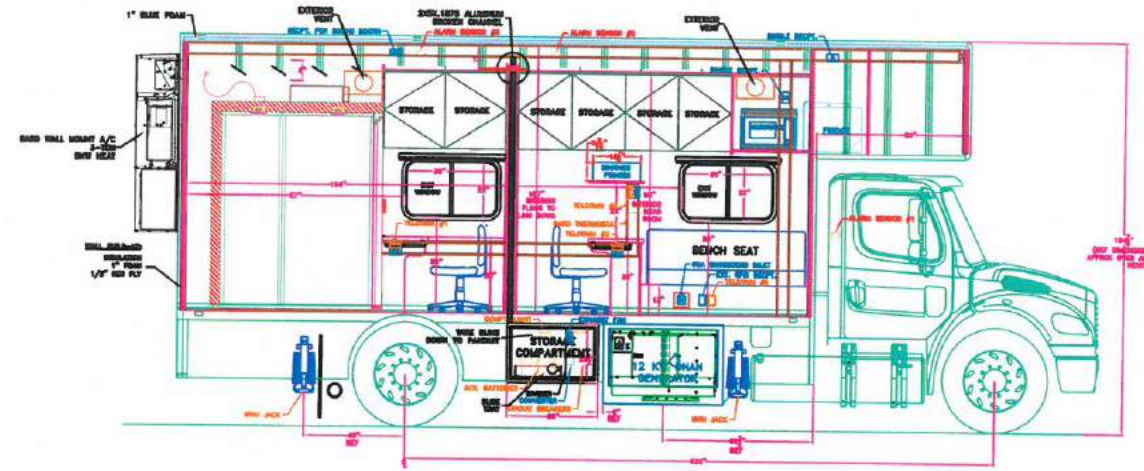

CUSTOMER APPROVAL
 PREPARED BY
 REVISED DATE

FARBER
 SPECIALTY VEHICLES

DESIGNER
 DRAWING NO.
 DATE

DESIGN ENGINEER: B. HANLEY	DATE: 1-18-16	CUSTOMER: FSV BODY 20' - HEALTH
ELAP ENGINEER		
EXCISEL APPROVAL		
SALES: PROPERLY AND CONFIDENTIAL		
7050 AMERICANA PARKWAY		
COLUMBUS, OH 43068		
USA		
UNLESS OTHERWISE SPECIFIED: DIMENSIONS IN INCHES DIMENSIONS IN MILLIMETERS DIMENSIONS IN METERS		
SCALE: E	LINE NO: 16302	REV: 1
DATE PLOTTED:		

**MODEL: FSV BODY 24
COMMAND – COMMUNICATIONS – EOD**

24'Box, 33' overall length, 260 hp diesel engine, 26,000 GVWR, Allison 3000 EVS automatic 6 speed, 60 gallon fuel tank, two air conditioners, interior and exterior LED light package, scene lights. Magnetic/hydraulic 12V and 120V circuit breakers, electronic master disconnect switches for main and auxiliary battery system, 36' shoreline. Four workstations, conference room, galley with under counter refrigerator, coffee maker and microwave. Custom cabinets cut using CNC router. Whiteboard finish on overhead cabinet doors.



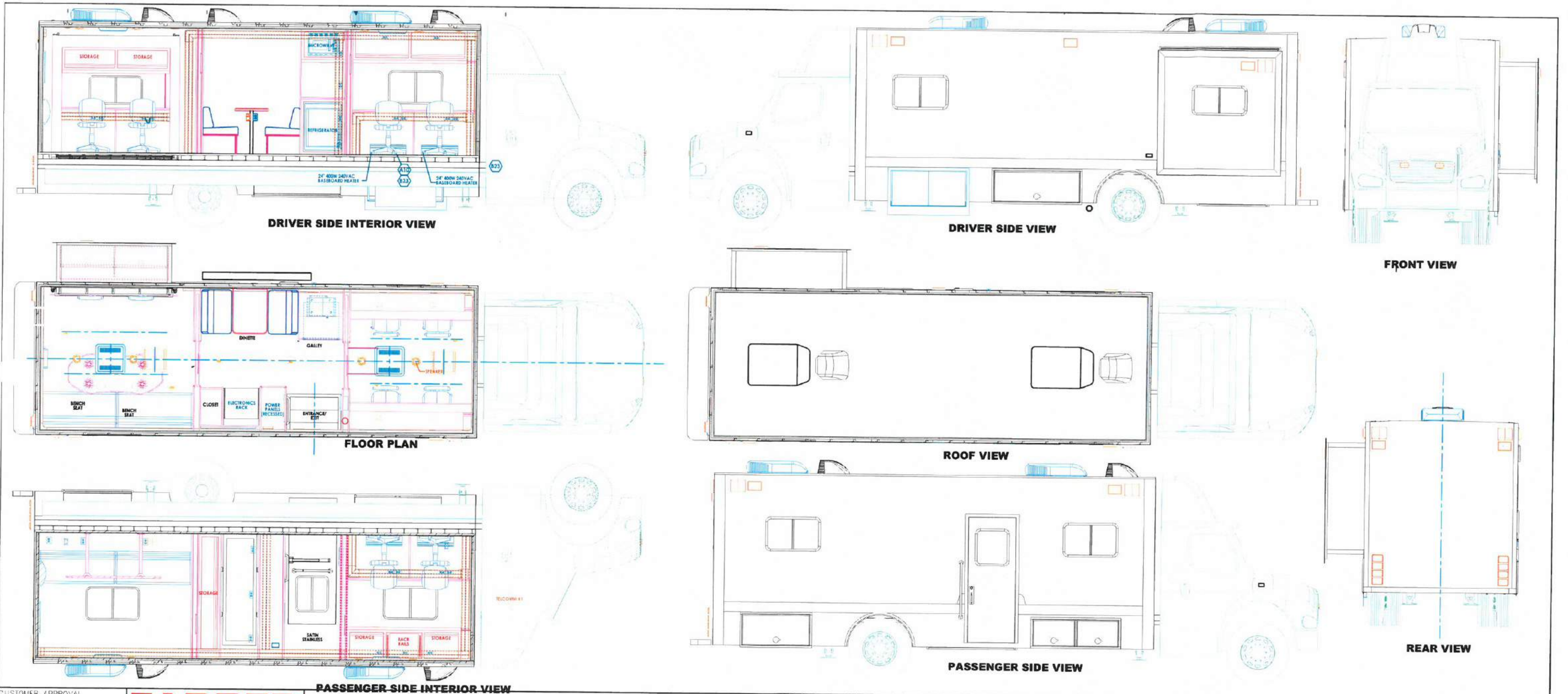

CUSTOMER APPROVAL
 PRINT NAME _____
 SIGNATURE _____ DATE _____

FARBER
SPECIALTY VEHICLES
 7052 AMERICANA PARKWAY
 COLUMBUS, OH 43068
 USA

PASSENGER SIDE INTERIOR VIEW

REV. 1	DESCRIPTIONS MADE - RH	1-14-16	REVISED
REV. 2	REVISIONS MADE - RH		
UNLESS OTHERWISE SPECIFIED ALL DIMENSIONS ARE IN INCHES DIMENSIONS IN PARENTHESES ARE IN MILLIMETERS		PROPRIETARY AND CONFIDENTIAL U.S. COMMUNITIES 16172	
SCALE: 1:24		DATE: 1-14-16 DRAWN BY: [Name] CHECKED BY: [Name]	
D		F.2	

**MODEL: FSV BODY 30
COMMAND – COMMUNICATIONS – EOD –**

39' overall length, 325 hp diesel engine, 33,000 GVWR, Allison 3000 EVS automatic 6 speed air brake package, 60 gallon fuel tank, three air conditioners, group 31 deep-cycle batteries, interior LED light package, magnetic/hydraulic 12V and 120V circuit breakers, electronic master disconnect switches for main and auxiliary battery system, 36' shoreline. Six workstations, conference room, Custom cabinets cut using CNC router. Whiteboard finish on overhead cabinet doors. Optional tandem axle available.



MODEL: FSV STEPVAN 20
Mobile Command

29' 6" overall length, Freightliner MT-55 chassis, Cummins 6.7L, 260HP diesel front engine, 26,000 GVWR. Allison 2500 series automatic transmission. Aluminum body construction with chrome front bumper, air brake package with ABS, 60 gallon fuel tank, power steering, remote control, heated exterior cab mirrors, two dashboard controlled electric windshield fans, Magnum high-back swivel driver and passenger seats, overhead storage cabinets. Commercial grade vinyl flooring two roof air conditioners, electric heat, 12V magnetic/hydraulic circuit breakers, electronic master disconnect switches for main and auxiliary battery system, 90 amp. converter, 36' shoreline. Custom cabinets cut using CNC router.

Space is designed for efficiency and ergonomic function for an optimized workflow. Custom options for restroom, additional entrances and awnings. See price sheet for details.



**MODEL: FSV BODY 32
BOMB RESPONSE - COMMAND**

40' overall length, 330 hp Cummins ISC diesel engine, 54,600 GVWR, 40,000 lb. tandem rear axle w/ airliner suspension, 14,600 lb. front suspension, Allison 3000 EVS automatic 6 speed, driver controlled traction differential, 270 amp alternator, air brake package w/ air dryer heater, dual 50 gallon fuel tanks w/ heaters, chromed steel front bumper, aluminum outside wheels, air horns, power heated mirrors, electric door locks, air suspension driver and passenger seats w/ armrests, adjustable tilt steering column, AM/FM/CD/MP3 radio. Aluminum exterior skin, three air conditioners, interior and interior LED light package, magnetic/hydraulic 12V and 120V circuit breakers, electronic master disconnect switches for main and auxiliary battery system, 36' shoreline. Up to six workstations available.



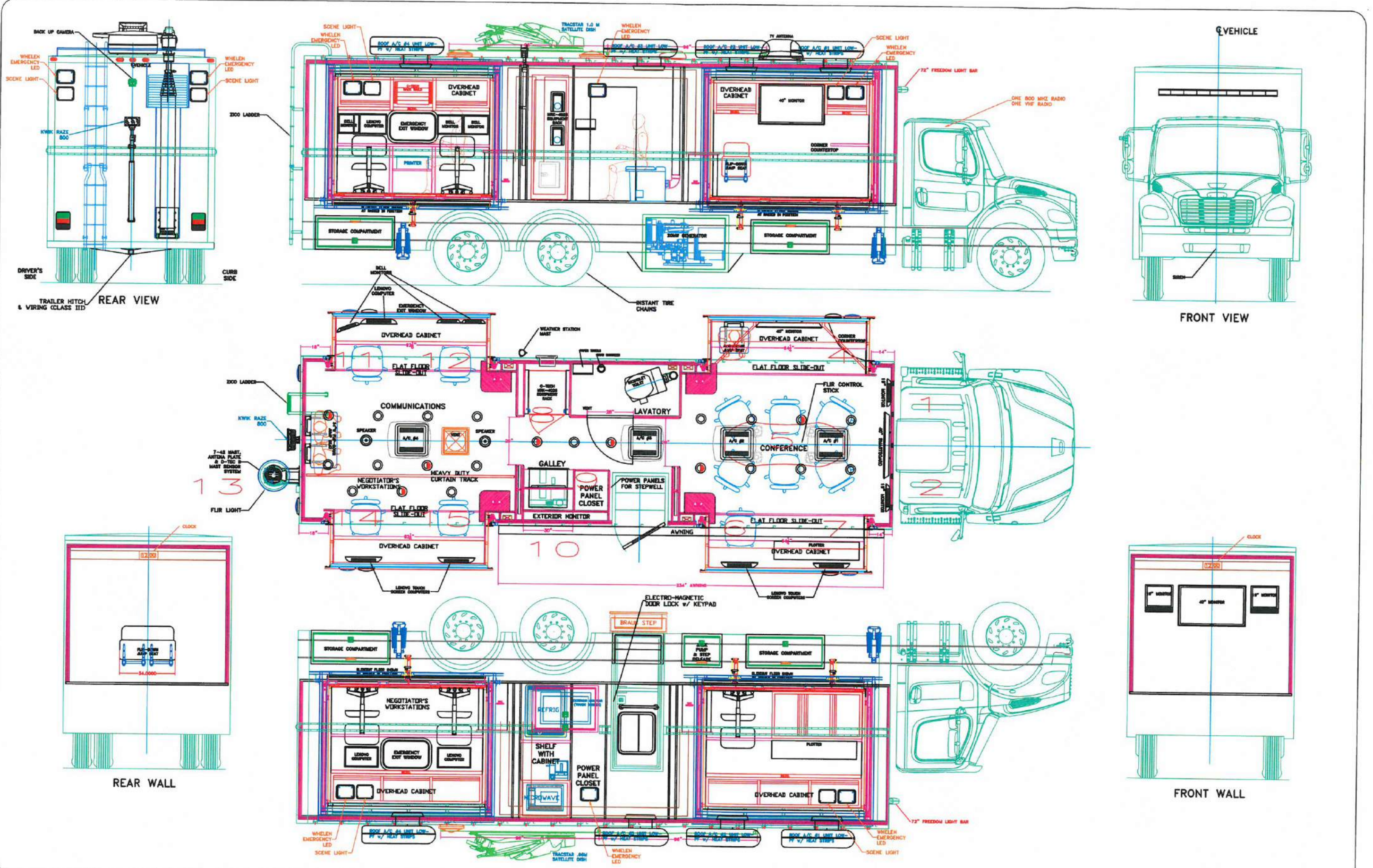

DATE 00	SCALE 1/2" = 12"	SHEET 01	OF 1
DRAWN BY GS	PLAT D/P.5-12	DATE TO	
BODY 32' BOX	CHASSIS NO.		
CHASSIS FREIGHTLINER M2	REV A.1		00000

**MODEL: FSV STEPVAN 26
Mobile Command**

35' 6" overall length, Freightliner MT-55 chassis, Cummins 6.7L, 300HP diesel front engine, 26,000 GVWR. Allison 2200 series automatic transmission. Aluminum body construction with chrome front bumper, air brake package with ABS, 60 gallon fuel tank, power steering, remote control, heated exterior cab mirrors, two dashboard controlled electric windshield fans, Magnum high-back swivel driver and passenger seats, overhead storage cabinets. Commercial/medical grade vinyl flooring three roof air conditioners, electric heat, 12V magnetic/hydraulic circuit breakers, electronic master disconnect switches for main and auxiliary battery system, 90 amp. converter, 36' shoreline. Custom cabinets cut using CNC router.

Space is designed for efficiency and ergonomic function for an optimized workflow. Floor plan includes four blood draw tables, screening room, waiting area and lab area. Custom options for restroom, additional entrances and awnings. See price sheet for details.



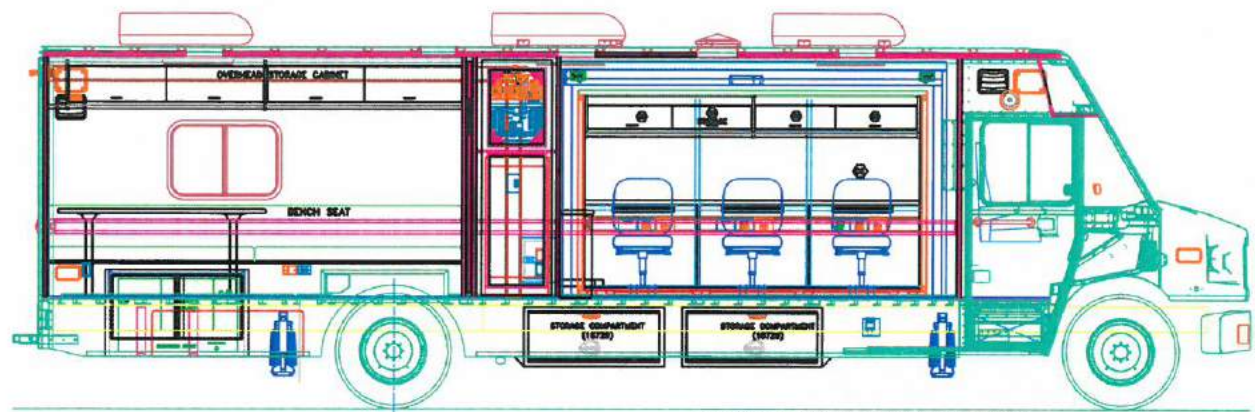

DRIVER SIDE INTERIOR VIEW

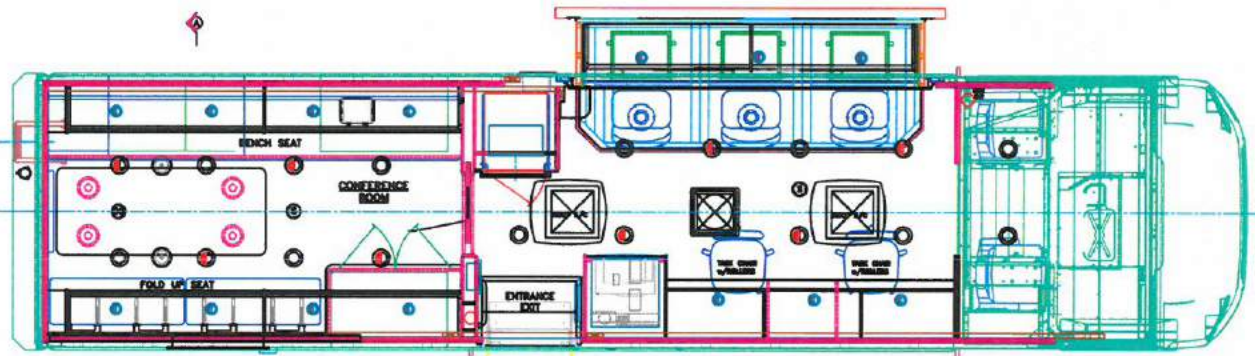

FLOOR PLAN

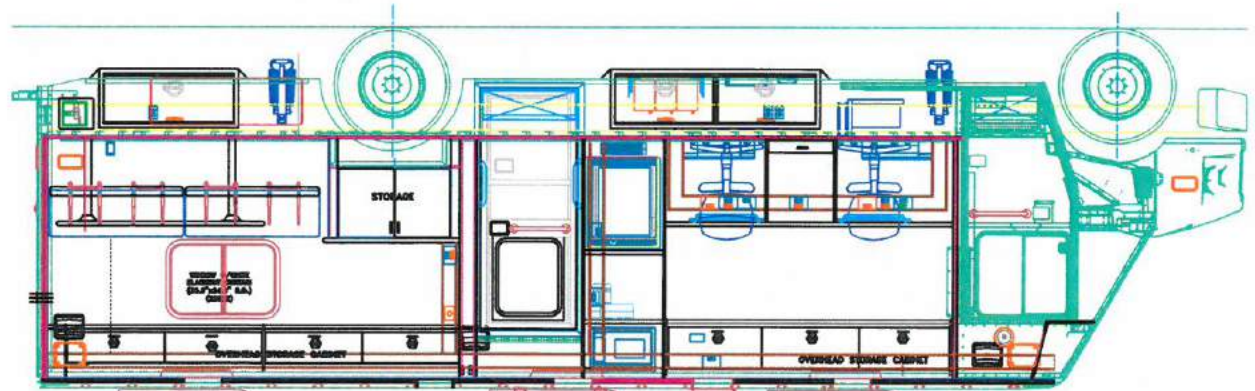

PASSENGER SIDE INTERIOR VIEW

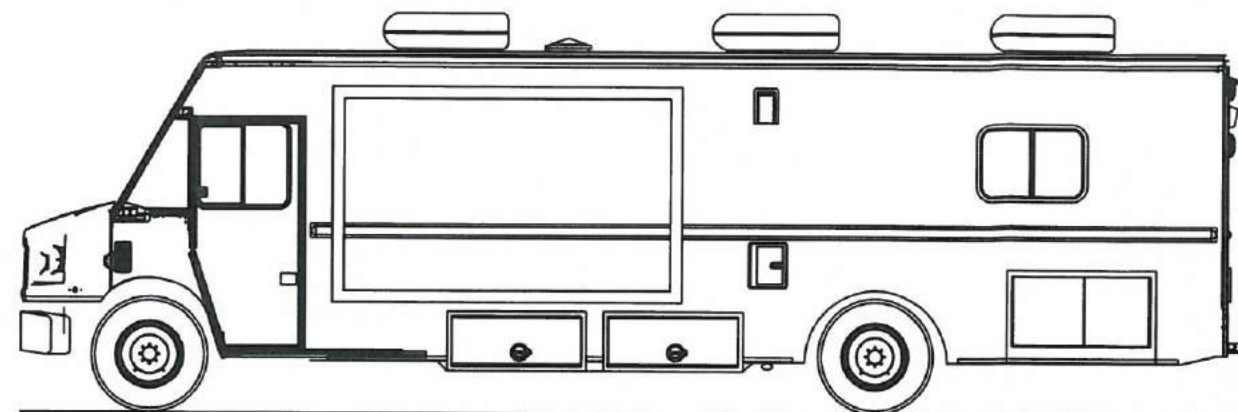

DRIVER SIDE VIEW

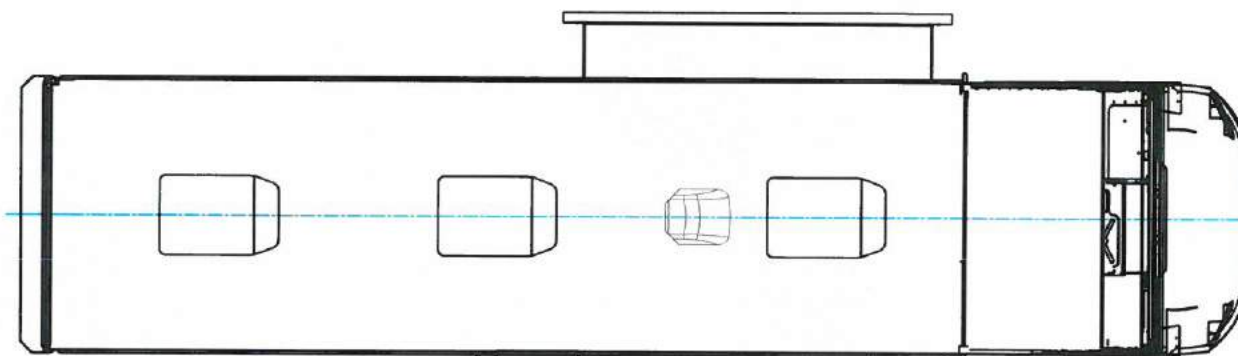

ROOF VIEW



PASSENGER SIDE VIEW

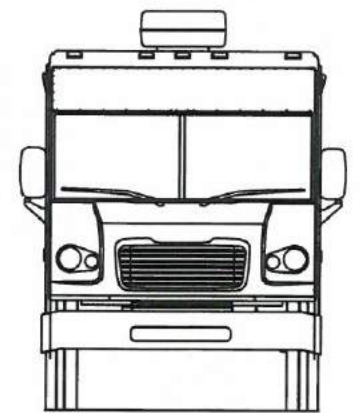

FRONT VIEW

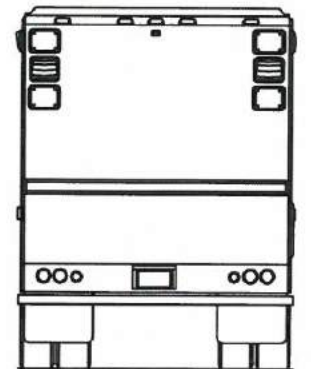

REAR VIEW

CUSTOMER APPROVAL

PRINT NAME

DATE

FARBER
SPECIALTY VEHICLES
7052 AMERICANA PARKWAY
COLUMBUS, OH 43068
USA

NOV
UNLESS OTHERWISE SPECIFIED
DIMENSIONS ARE IN INCHES
DIMENSIONS IN METERS
DIMENSIONS IN FEET
DIMENSIONS IN MILLIMETERS

DESIGN ENGINEER: GIERHART-BEI
ELEC ENGINEER: T. DENNIS
ENG MGR APPROVAL
SALES: T. GOODYEAR
PROPRIETARY AND CONFIDENTIAL

CUSTOMER: FSV STEPVAN 26
TITLE: US COMMUNITIES
SHEET NO: E
SCALE: 1/8" = 1'-0"
UNIT NO: 15612

REV A.5
SHEET 1 OF 1

**MODEL: FSV STEPVAN 30
Mobile Command**

39' 6" overall length, Freightliner MT-55 chassis, Cummins 6.7L, 300HP diesel front engine, 30,000 GVWR. Allison 2200 series automatic transmission. Aluminum body construction with chrome front bumper, air brake package with ABS, 60 gallon fuel tank, power steering, remote control, heated exterior cab mirrors, two dashboard controlled electric windshield fans, Magnum high-back swivel driver and passenger seats, overhead storage cabinets. Commercial grade vinyl flooring two roof air conditioners, electric heat, 12V magnetic/hydraulic circuit breakers, electronic master disconnect switches for main and auxiliary battery system, 90 amp. converter, 36' shoreline. Custom cabinets cut using CNC router.

Space is designed for efficiency and ergonomic function for an optimized workflow. Custom options for restroom, additional entrances and awnings. See price sheet for details.



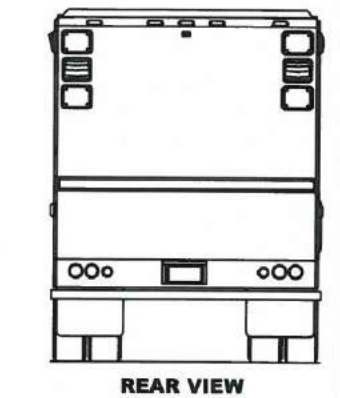
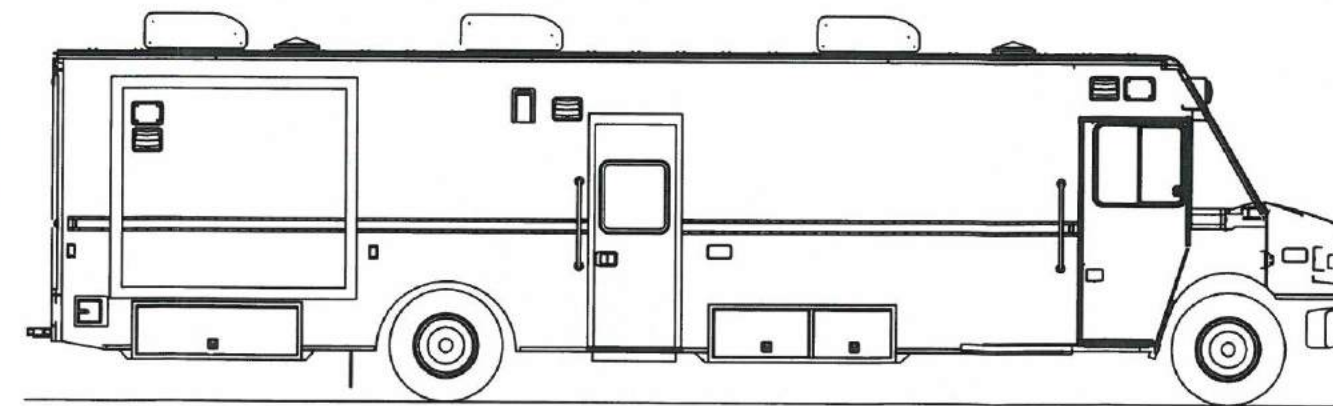
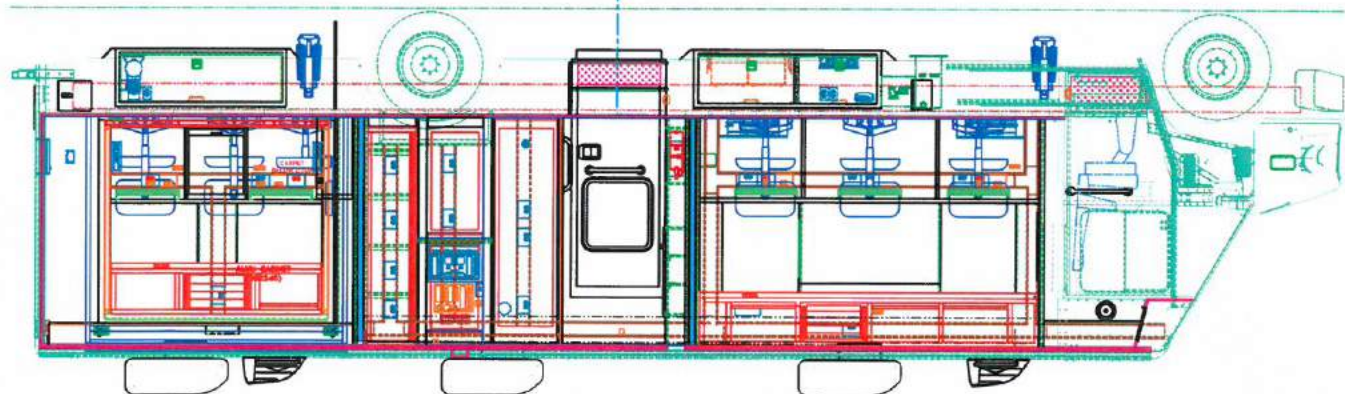
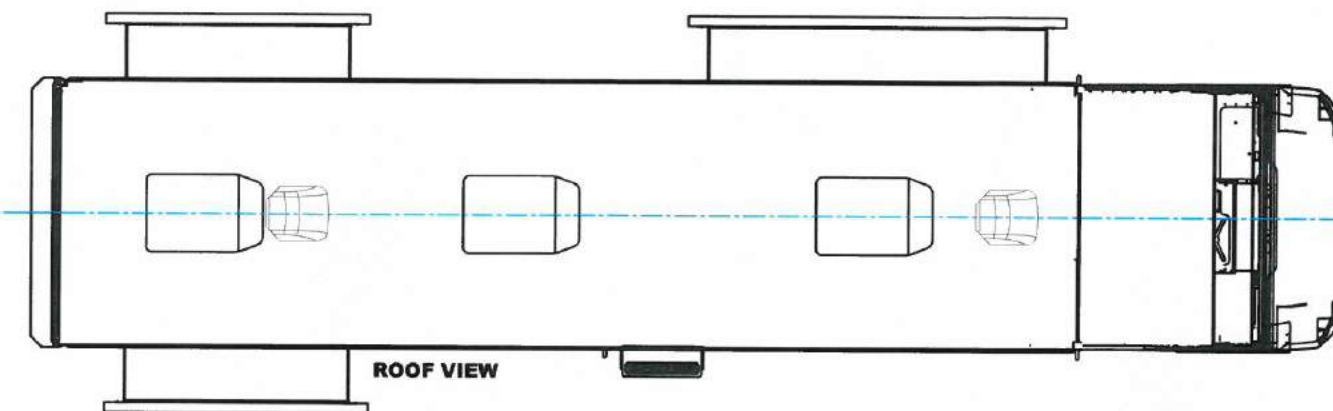
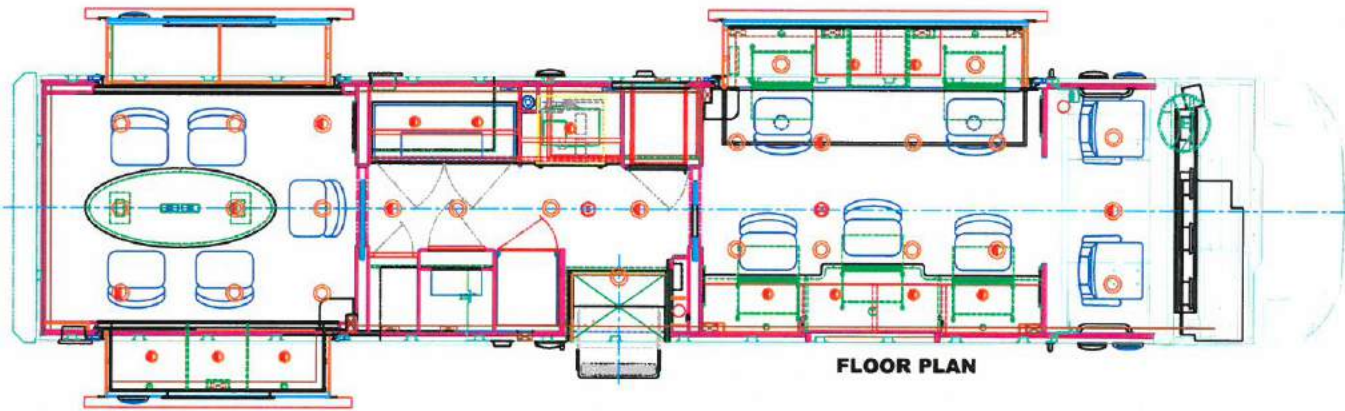
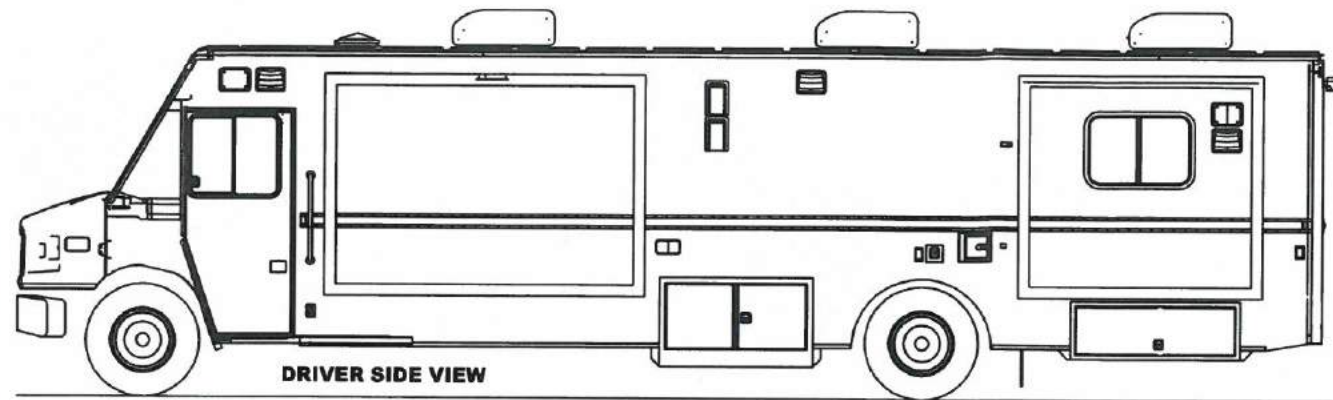
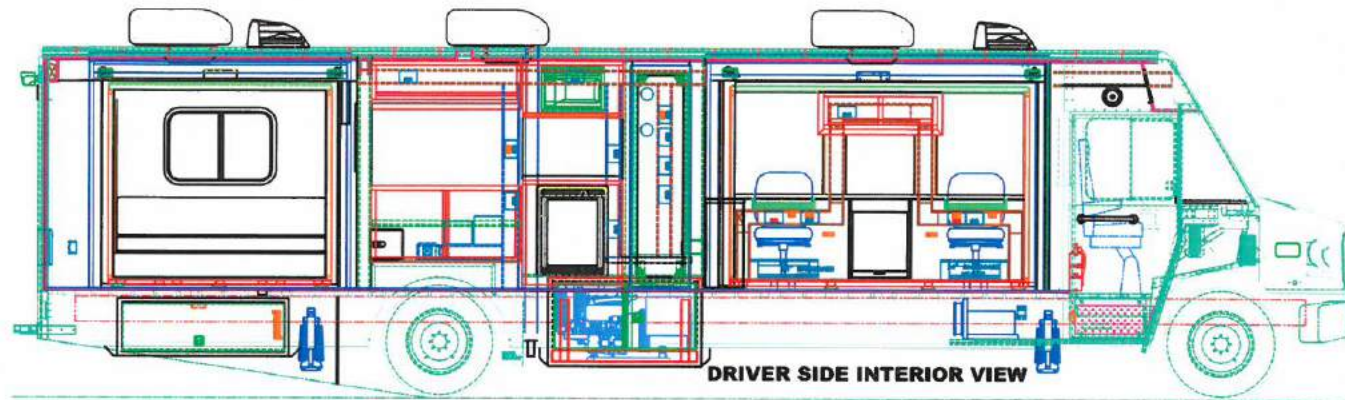

CUSTOMER APPROVAL
 SIGNATURE _____
 DATE _____

FARBER
 SPECIALTY VEHICLES
 7057 AMERICANA PARKWAY
 COLUMBUS, OH 43068
 USA

UNLESS OTHERWISE SPECIFIED
 ALL DIMENSIONS ARE IN INCHES
 DIMENSIONS IN PARENTHESES ARE IN MILLIMETERS
 DIMENSIONS IN METERS ARE IN PARENTHESES

DESIGN ENGINEER: CIZERMART-BH 1-34-98
 ELEC. ENGINEER: J. DENNIS
 ENG. MGR. APPROVAL: _____
 SALES: T. GOODYEAR
 PROPRIETARY AND CONFIDENTIAL
 ALL RIGHTS RESERVED
 THIS DRAWING IS THE PROPERTY OF FARBER SPECIALTY VEHICLES
 IT IS TO BE USED ONLY FOR THE PROJECT AND VEHICLE IDENTIFIED
 HEREON. IT IS NOT TO BE REPRODUCED OR TRANSMITTED IN ANY FORM
 OR BY ANY MEANS, ELECTRONIC OR MECHANICAL, INCLUDING PHOTOCOPYING,
 RECORDING, OR BY ANY INFORMATION STORAGE AND RETRIEVAL SYSTEM.

CUSTOMER	FSV STEPVAN 30		
TITLE	US COMMUNITIES		
SHEET SIZE	SCALE	UNIT NO.	REV
E		15796	A.5

SHOET 1 OF 1

MODEL: FSV STEPVAN 30 MOBILE MEDICAL HEALTH VEHICLE

39' 6" overall length, Freightliner MT-55 chassis, Cummins 6.7L, 300HP diesel front engine, 29,000 GVWR. Allison 2500 series automatic transmission. Aluminum body construction with chrome front bumper, air brake package with ABS, 90 gallon fuel tank, power steering, remote control, heated exterior cab mirrors, two dashboard controlled electric windshield fans, Magnum high-back swivel driver and passenger seats, overhead storage cabinets. Commercial/medical grade vinyl flooring three roof air conditioners, electric heat, 12V magnetic/hydraulic circuit breakers, electronic master disconnect switches for main and auxiliary battery system, 90 amp. converter, 36' shoreline. Custom cabinets cut using CNC router.

Space is designed for efficiency and ergonomic function for an optimized workflow. Floor plan includes two exam rooms, intake/reception area, waiting area and lab area. Custom options for restroom, ADA accessibility, testing equipment, additional entrances and awnings. See price sheet for details.



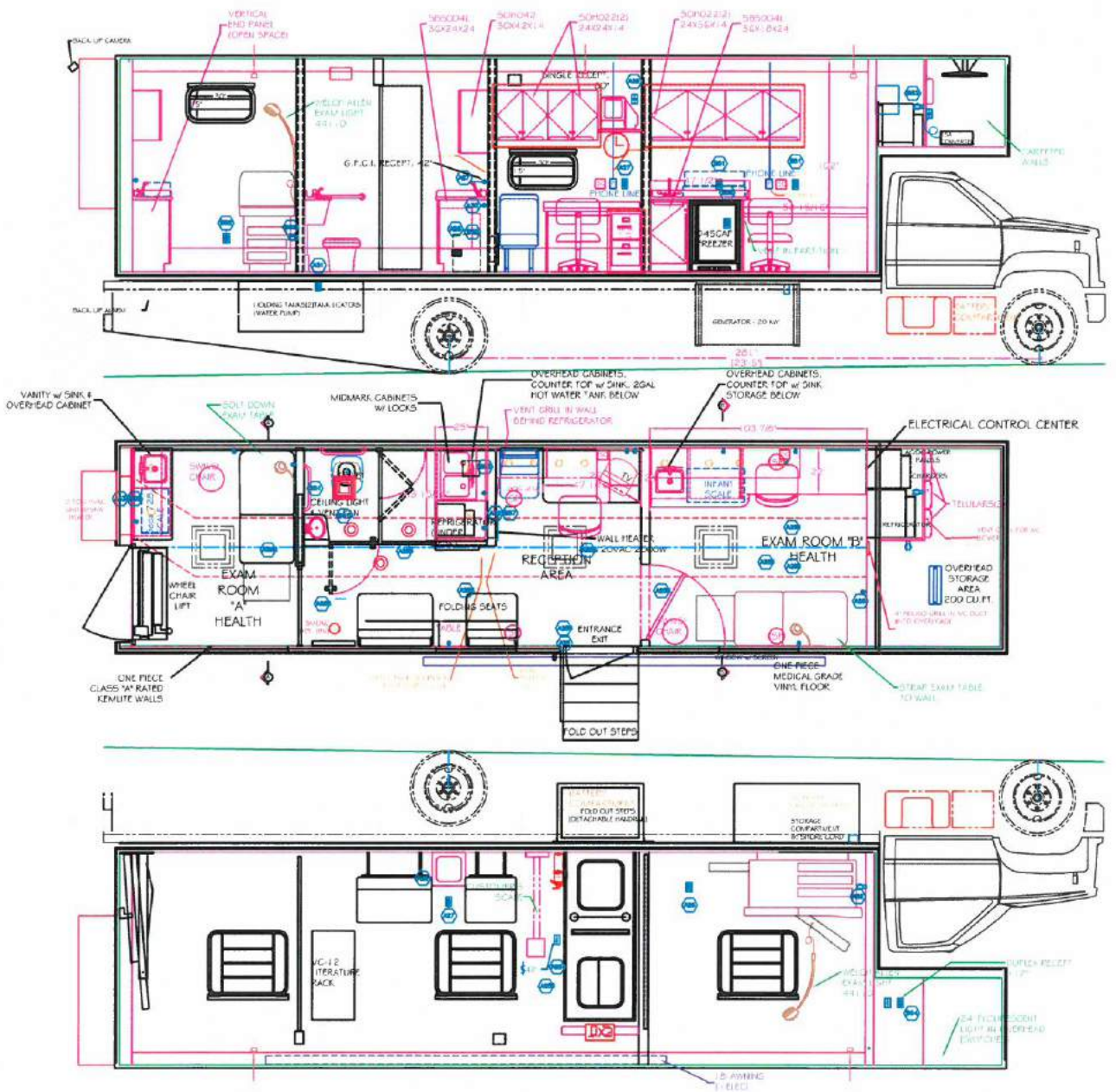

CUSTOMER APPROVAL _____
 PRINT NAME _____
 SIGNATURE _____ DATE _____

FARBER
 SPECIALTY VEHICLES
 7052 AMERICANA PARKWAY
 COLUMBUS, OH 43068
 USA

MODEL: FSV COACH STYLE 33 MOBILE COMMAND

33'6" overall length, 6.8L, 362HP, gasoline powered, 24,000 GVWR, 75 gallon fuel tank, 102" exterior width, aluminum frame body construction, fiberglass exterior, flat interior floor/ no wheel wells, drivers door, main entrance door equipped with electric steps, aluminum outer wheels,. Remote control, heated exterior cab mirrors. High back, swivel, driver and passenger seats. Two dashboard controlled electric windshield fans. Commercial / medical grade vinyl flooring. Three roof air conditioners with central ducting, electric heat, magnetic/hydraulic 12V circuit breakers, electronic master disconnect switches for main and auxiliary battery system, 90 amp. converter, 36' shoreline. Custom cabinets cut using CNC router.

Space is designed for efficiency and ergonomic function for an optimized workflow. Floor plan includes two exam rooms, intake/reception area, waiting area and lab area. Custom options for restroom, ADA accessibility, testing equipment, additional entrances and awnings. See price sheet for details.



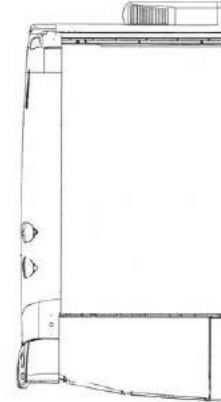
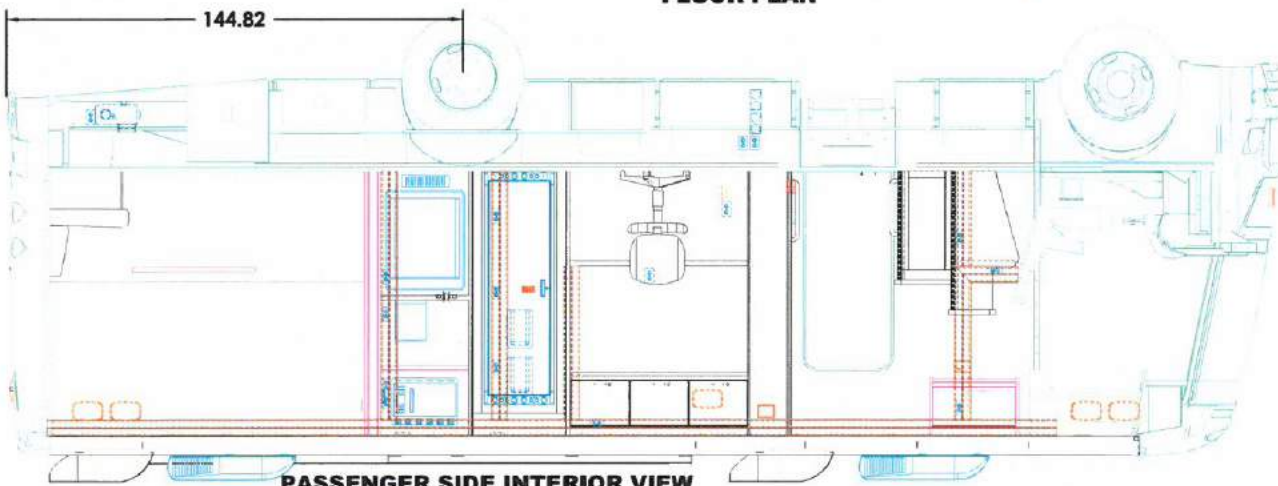
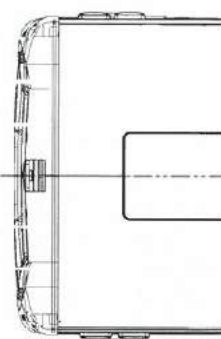
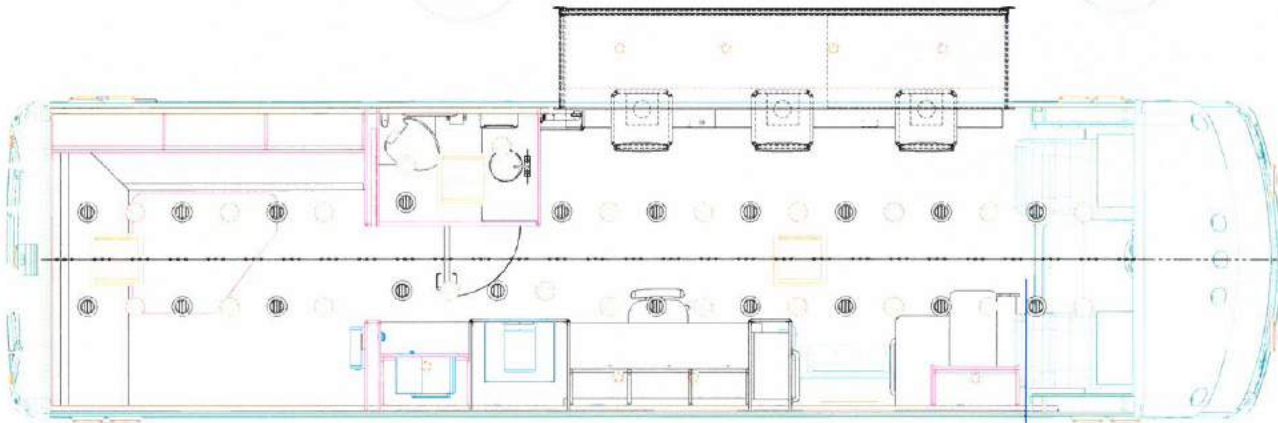
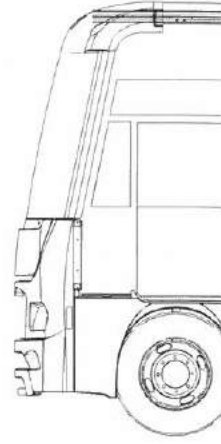
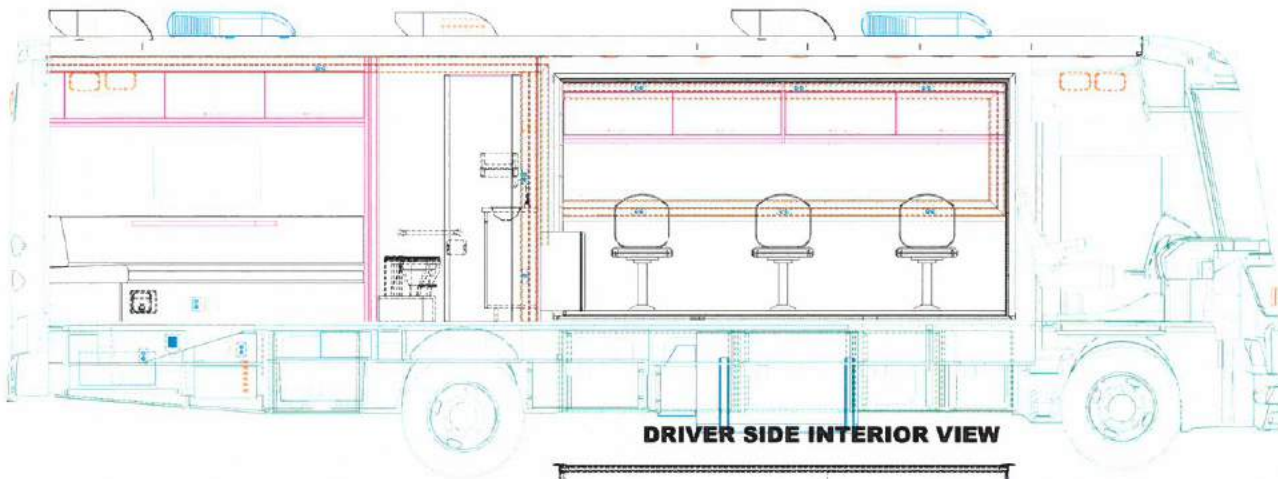

144.82

CUSTOMER APPROVAL

PRINT NAME _____

SIGNATURE _____ DATE _____

FARBER
SPECIALTY VEHICLES
 7852 AMERICANA PARKWAY
 COLUMBUS, OH 43068
 USA

**MODEL: FSV COACH STYLE 38
BLOODMOBILE 38'**

38'6" overall length, 6.8L, 362HP, gasoline powered, 22,000 GVWR, 10Kw water cooled commercial generator, 75 gallon fuel tank, 102" exterior width, aluminum frame body construction, fiberglass exterior, flat interior floor/ no wheel wells, drivers door, main entrance door equipped with electric steps, aluminum outer wheels, 5000 lb. rated trailer hitch. Remote control, heated exterior cab mirrors. High back, swivel, driver and passenger seats. Two dashboard controlled electric windshield fans. Built in dash monitor for rearview backup camera system. Commercial / medical grade vinyl flooring. Three roof air conditioners with central ducting, electric heat, automatic computerized hydraulic leveling/stabilizing system, magnetic/hydraulic 12V circuit breakers, electronic master disconnect switches for main and auxiliary battery system, 90 amp. converter, 36' shoreline. Custom cabinets cut using CNC router.

Space is designed for efficiency and ergonomic function for an optimized workflow. Floor plan includes four blood draw tables, screening room, waiting area and lab area. Custom options for restroom, additional entrances and awnings. See price sheet for details.



MODEL: FSV COACH STYLE 38 MOBILE DENTAL VEHICLE

38'6" overall length, 6.8L, 362HP, gasoline powered, 24,000 GVWR, 75 gallon fuel tank, 102" exterior width, aluminum frame body construction, fiberglass exterior, flat interior floor/ no wheel wells, drivers door, main entrance door equipped with electric steps, aluminum outer wheels, Remote control, heated exterior cab mirrors. High back, swivel, driver and passenger seats. Two dashboard controlled electric windshield fans. Commercial / medical grade vinyl flooring. Three roof air conditioners with central ducting, electric heat, magnetic/hydraulic 12V circuit breakers, electronic master disconnect switches for main and auxiliary battery system, 90 amp. converter, 36' shoreline. Custom cabinets cut using CNC router.

Space is designed for efficiency and ergonomic function for an optimized workflow. Floor plan includes two or three operatories, intake/reception area, waiting area and sterilization center. Custom options for restroom, ADA accessibility, additional entrances and awnings. See price sheet for details and packages of dental chairs, X-rays, sterilization and other dental equipment.



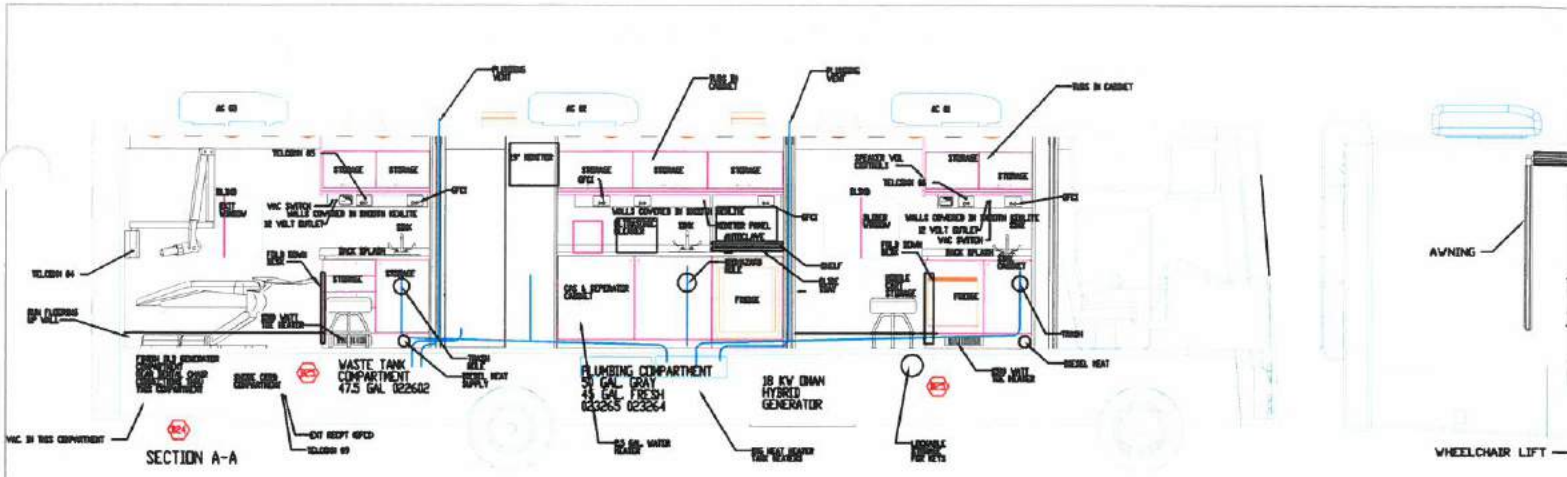

SECTION A-A

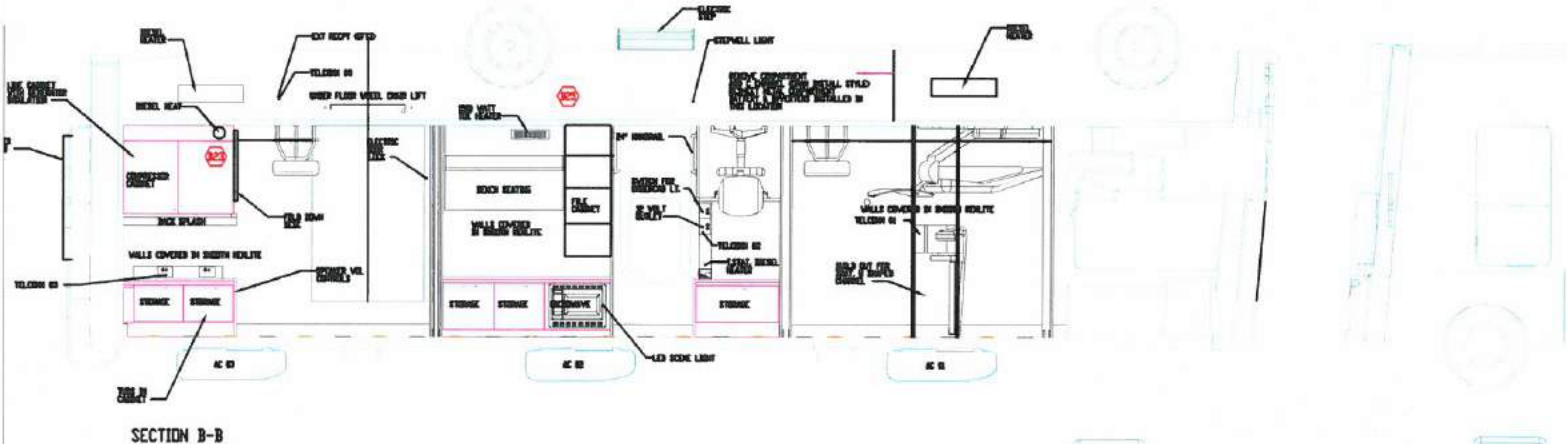
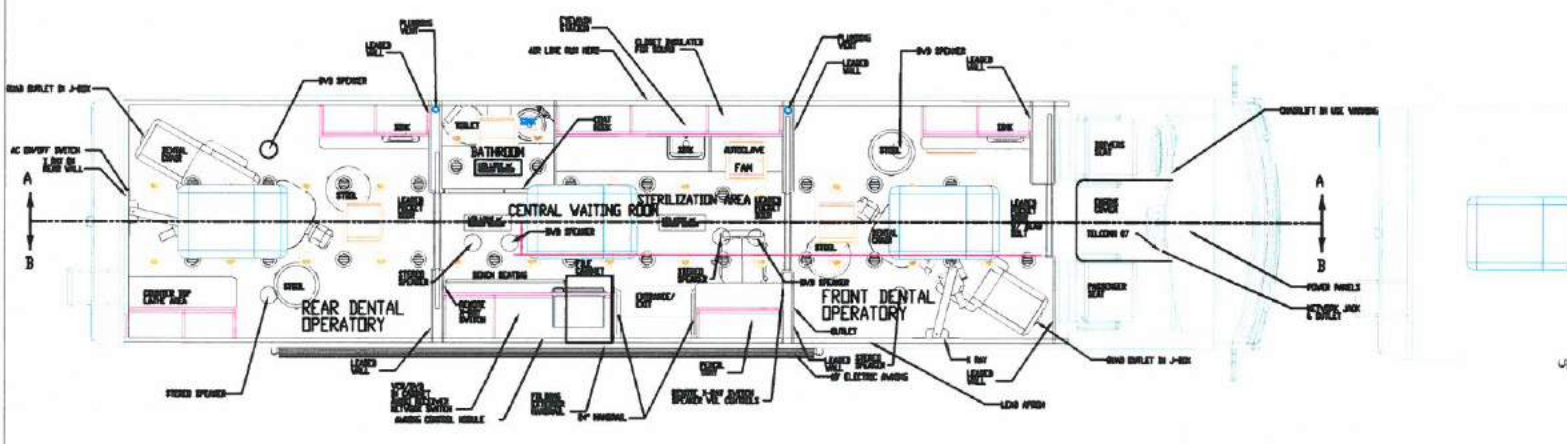

SECTION B-B

CUSTOMER APPROVAL	
PRINT NAME	
ADDRESS	
DATE	

FARBER
SPECIALTY VEHICLES
7052 AMERICANA PARKWAY
COLUMBUS, OH 43068
USA

REV	
CHG	
UNLESS OTHERWISE SPECIFIED ALL DIMENSIONS ARE IN INCHES	
SCALE 1/4" = 1'-0"	

**MODEL: FSV COACH STYLE 38
MOBILE COMMAND CENTER, CSI, DUI**

38'6" overall length, 6.7L Cummins, 340HP diesel engine, 26,000 GVWR, 80 gallon fuel tank, 102" exterior width, aluminum frame body construction, fiberglass exterior, flat interior floor/ no wheel wells, drivers door, main entrance door equipped with electric steps, aluminum outer wheels, Remote control, heated exterior cab mirrors. High back, swivel, driver and passenger seats. Two dashboard controlled electric windshield fans. Commercial one-piece vinyl flooring. Three roof air conditioners with central ducting, electric heat, magnetic/hydraulic 12V and 120V circuit breakers, electronic master disconnect switches for main and auxiliary battery system, 90 amp. converter, 36' shoreline. Custom options, additional entrances and awnings. See price sheet for details and packages of Command, DUI and CSI equipment.



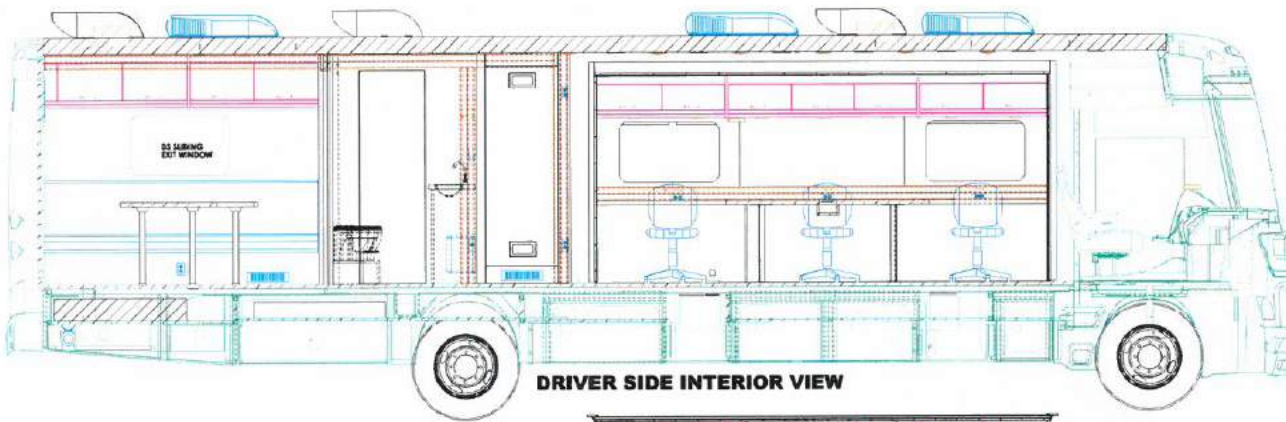

DRIVER SIDE INTERIOR VIEW

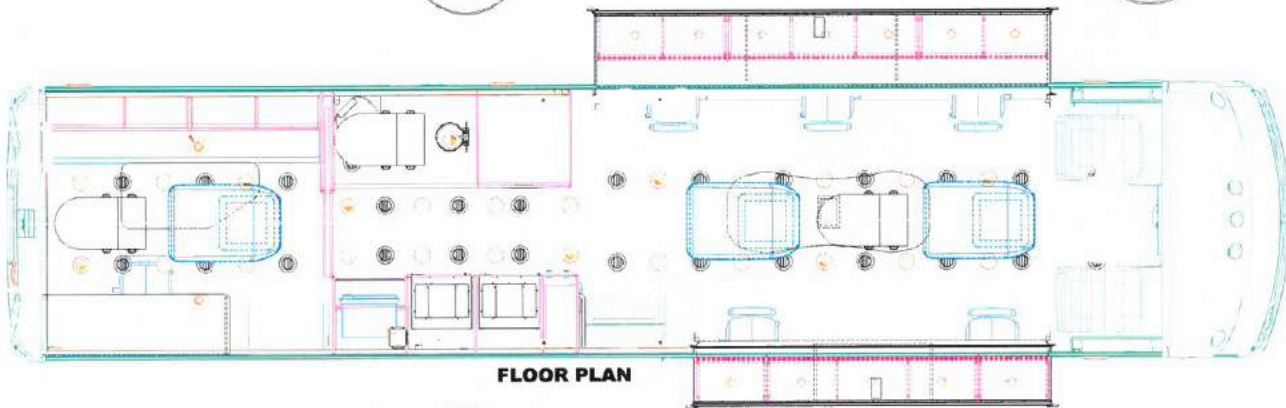
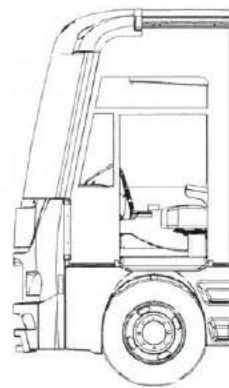

FLOOR PLAN

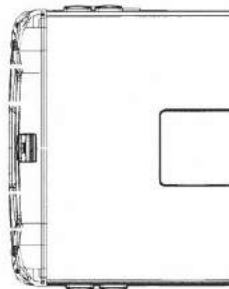

ROOF

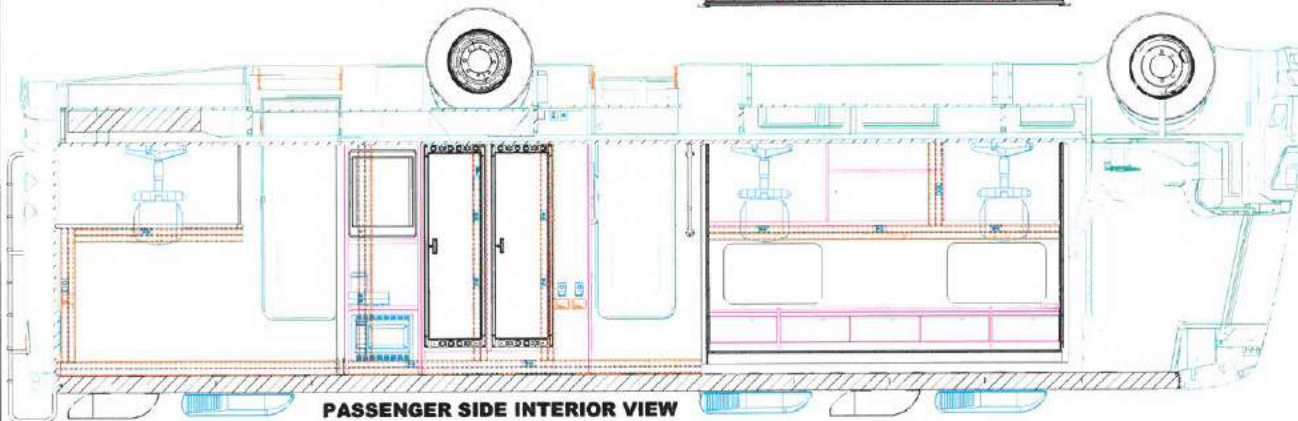

PASSENGER SIDE INTERIOR VIEW

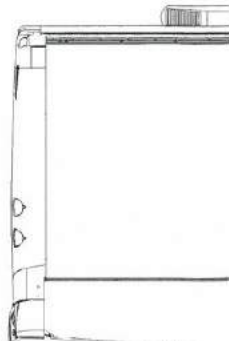

PASSENGER

CUSTOMER APPROVAL
 BUILD NAME
 BUILD TYPE DATE

FARBER
 SPECIALTY VEHICLES

MODEL: FSV COACH STYLE 38 BOOKMOBILE

38'6" overall length, 6.8L, 362HP, gasoline powered, 24,000 GVWR, 75 gallon fuel tank, 102" exterior width, aluminum frame body construction, fiberglass exterior, flat interior floor/ no wheel wells, drivers door, main entrance door equipped with electric steps, aluminum outer wheels,. Remote control, heated exterior cab mirrors. High back, swivel, driver and passenger seats. Two dashboard controlled electric windshield fans. Commercial / medical grade vinyl flooring. Three roof air conditioners with central ducting, electric heat, magnetic/hydraulic 12V circuit breakers, electronic master disconnect switches for main and auxiliary battery system, 90 amp. converter, 36' shoreline. Custom cabinets cut using CNC router.

Space is designed for efficiency and ergonomic function for an optimized workflow. Floor plan includes two exam rooms, intake/reception area, waiting area and lab area. Custom options for restroom, ADA accessibility, testing equipment, additional entrances and awnings. See price sheet for details.



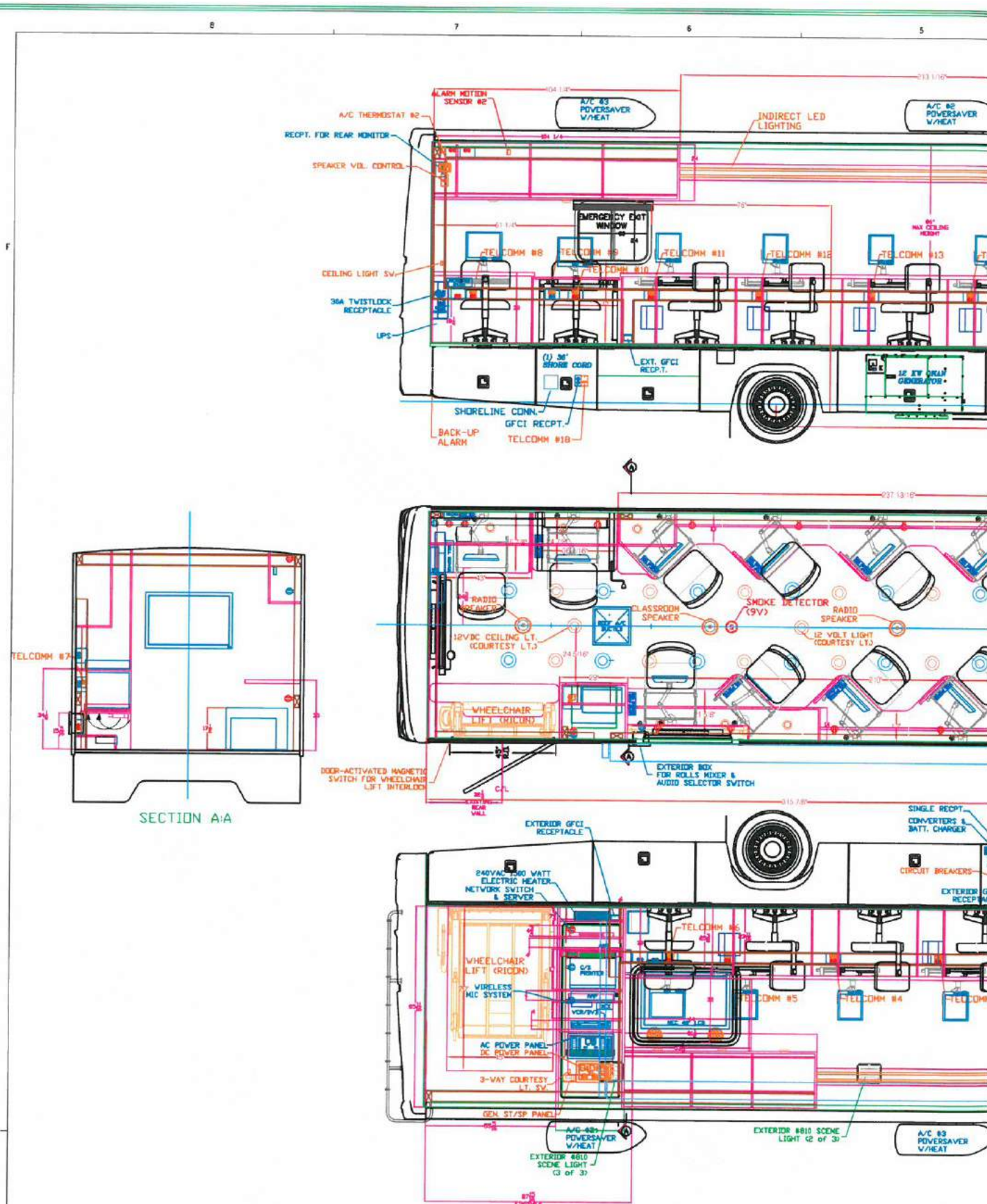

CUSTOMER APPROVAL

DATE	BY

FARBER
SPECIALTY VEHICLES
 7052 AMERICANA PARKWAY
 COLUMBUS, OH 43068
 USA

REVISION HISTORY

REV.	DESCRIPTION	ENGINEER
P.1	UPDATES AFTER PREBUILD MTG	B. HO
F.1	UPDATES AFTER BUILD MTG	B. HO

**MODEL: FSV CUSTOM COACH STYLE 40' (REAR ENGINE)
BLOODMOBILE COACH**

41'4" overall length, 8.3L, Cummins 400HP, diesel powered, rear engine, 33,000 GVWR, Allison 6-speed automatic, full air-suspension, air disc brakes, independent front suspension, 101" exterior width, aluminum frame body construction, fiberglass exterior, flat interior floor/ no wheel wells, main entrance door equipped with electric steps, aluminum outer wheels. Remote control, heated exterior cab mirrors. High back, swivel, driver and passenger seats. Two dashboard controlled electric windshield fans. Built in dash monitor for rearview backup camera system. Commercial/medical grade vinyl flooring. Three roof air conditioners, electric heat, automatic computerized hydraulic leveling/stabilizing system, magnetic/hydraulic 12V circuit breakers, electronic master disconnect switches for main and auxiliary battery system, 90 amp. Converter, 36' shoreline. Custom cabinets cut using CNC router.

Space is designed for efficiency and ergonomic function for an optimized workflow. Floorplan includes four blood draw tables, screening room(s), waiting area and lab area. Custom options for restroom, additional entrances and awnings. See price sheet for details.



**MODEL: FSV CUSTOM COACH STYLE 45' (REAR ENGINE)
Mobile Command, Medical, Classroom, STEM**

45'4" overall length, 8.3L, Cummins 450HP, diesel powered, rear engine, 44,600 GVWR, Allison 6-speed automatic, full air-suspension, air disc brakes, independent front suspension, 101" exterior width, aluminum frame body construction, fiberglass exterior, flat interior floor/ no wheel wells, main entrance door equipped with electric steps, aluminum outer wheels. Remote control, heated exterior cab mirrors. High back, swivel, driver and passenger seats. Two dashboard controlled electric windshield fans. Commercial/medical grade vinyl flooring. Three roof air conditioners, electric heat, magnetic/hydraulic 12V circuit breakers, electronic master disconnect switches for main and auxiliary battery system, 90 amp. Converter, 36' shoreline. Custom cabinets cut using CNC router.

Space is designed for efficiency and ergonomic function for an optimized workflow. Custom options for restroom, additional entrances, slideouts and awnings. See price sheet for details.



FSV TRAILER 16 MOBILE COMMAND - DUI BAT - COMMUNICATIONS TRAILER

16' overall length including tongue, 7,500 GVWR, 102" exterior width, Smooth, seamless and impact resistant FRP fiberglass walls. Bright white gel coat interior and exterior wall finish. 7,000 lb. jack and welded safety chains. Rear ramp door to be spring assisted and 96" wide. Two tinted 30" x 15" windows; day/night shades installed on windows. One grab handle at door location. Deluxe scissor jacks with hand crank. Commercial one piece vinyl flooring. One roof air conditioner, electric heat. 12V and 120V circuit breakers, electronic master disconnect switches for main and auxiliary battery system, 36' shoreline. Custom cabinets cut using CNC router.



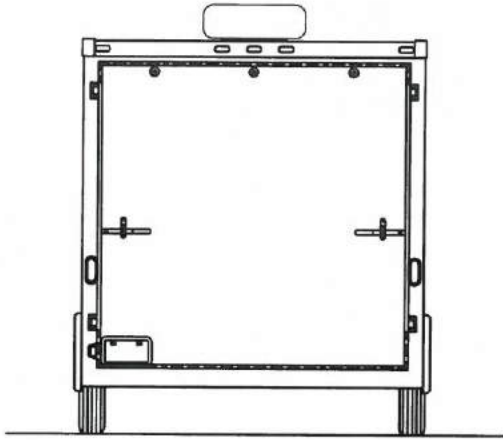

EXTERIOR REAR VIEW

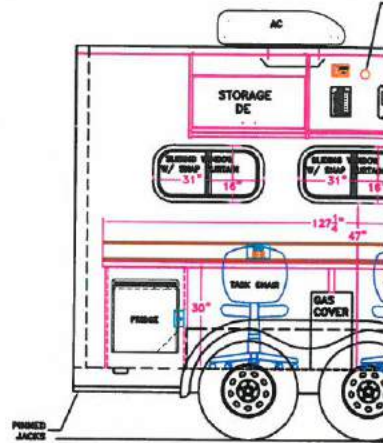

DRIVERS SIDE

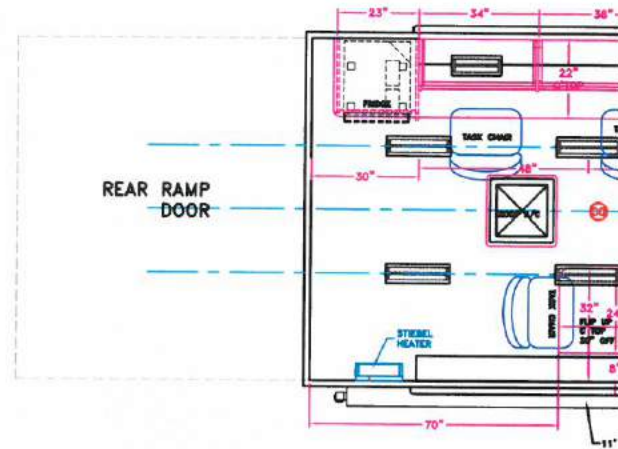

INTERIOR I

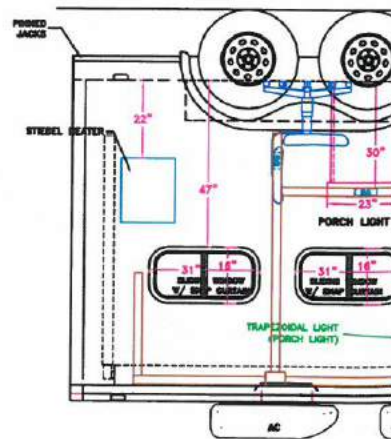

PASSENGER S

CUSTOMER APPROVAL	<p style="text-align: center; font-size: 2em; color: red;">FARBER</p> <p style="text-align: center;">SPECIALTY VEHICLES</p> <p style="text-align: center;">7052 AMERICANA PARKWAY COLUMBIANA, OH 43081 USA</p>	REVISION HISTORY
DATE		DESCRIPTION
DATE		DESCRIPTION

**MODEL: FSV PREVOST H3-45 45' (REAR ENGINE)
Mobile Command, Medical, Classroom**

45'4" overall length, Volvo D13, diesel powered, rear engine, 500HP, 54,500 GVWR, Allison World B500, six speed, automatic, full air-suspension, air disc brakes, independent front suspension, 101" exterior width, aluminum frame body construction, fiberglass exterior, flat interior floor/ no wheel wells, main entrance door equipped with electric steps, aluminum outer wheels. Remote control, heated exterior cab mirrors. High back, swivel, driver and passenger seats. Two dashboard controlled electric windshield fans. Commercial/medical grade vinyl flooring. Three roof air conditioners, electric heat, magnetic/hydraulic 12V circuit breakers, electronic master disconnect switches for main and auxiliary battery system, 90 amp. Converter, 36' shoreline. Custom cabinets cut using CNC router.

Space is designed for efficiency and ergonomic function for an optimized workflow. Custom options for restroom, additional entrances, slide-outs and awnings. See price sheet for details.



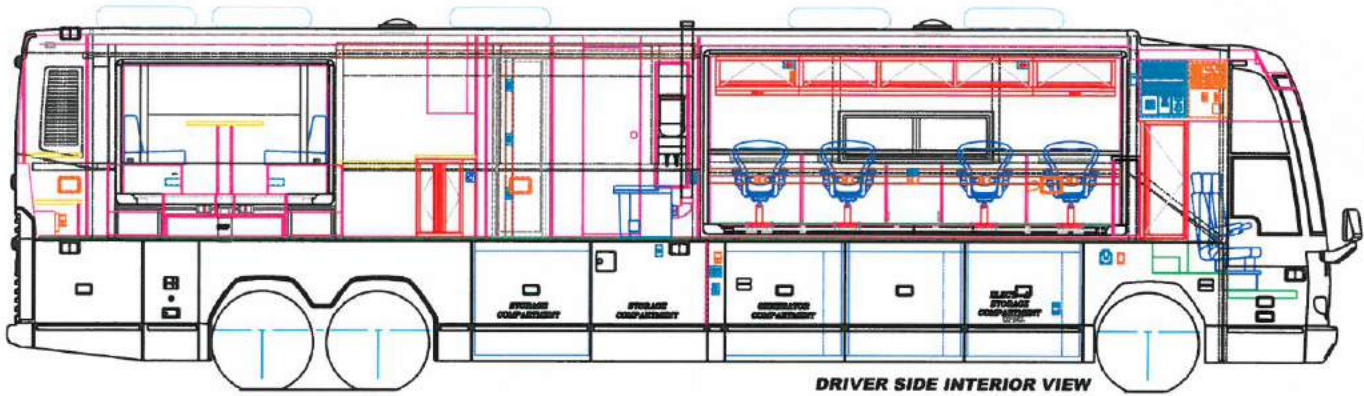

DRIVER SIDE INTERIOR VIEW

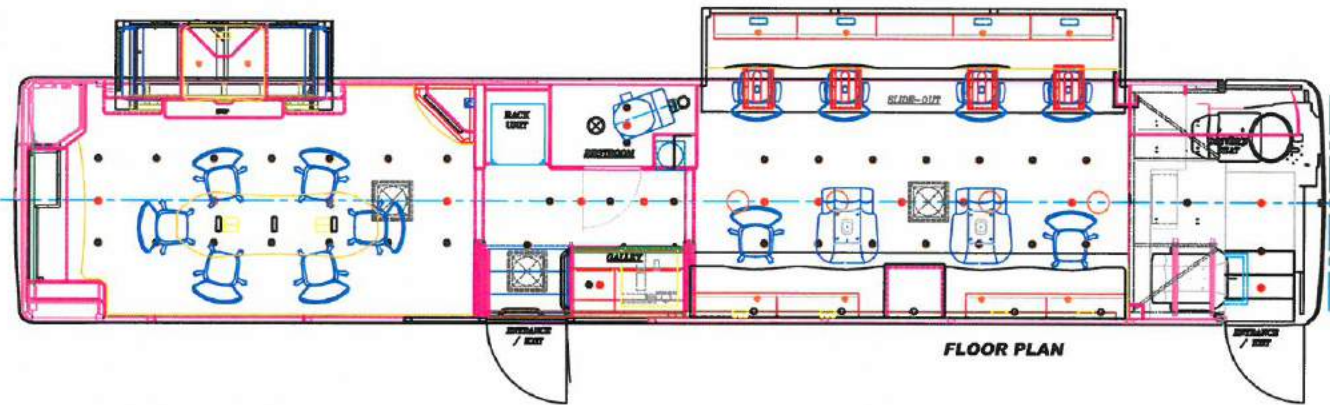

FLOOR PLAN

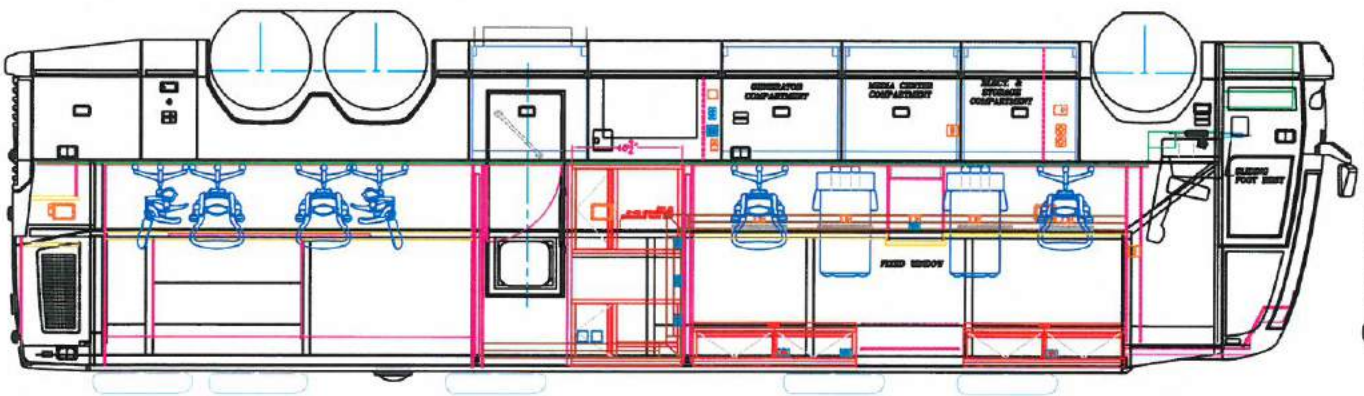

PASSENGER SIDE INTERIOR VIEW

CUSTOMER APPROVAL

PRINT NAME

SIGNATURE

DATE

FARBER
SPECIALTY VEHICLES

**FSV TRAILER 30
MOBILE MEDICAL ,HEALTH, DENTAL,COMMAND,CLASSROOM -**

Body 30', 34' overall length, 10,000 GVWR, 102" exterior width, Aluminum construction, welded safety chains. One grab handle at door location. Deluxe scissor jacks with hand crank. Fire rated fiberglass interior wall and ceiling finish, commercial/medical vinyl flooring. One roof mounted air conditioner, electric heat. 12V and 120V circuit breakers, electronic master disconnect switches for main and auxiliary battery system, 36' shoreline. Custom cabinets cut using CNC router.

Space is designed for efficiency and ergonomic function for an optimized workflow. Custom options for restroom, ADA accessibility, testing equipment, additional entrances and awnings. See price sheet for details. Alternative length options available.

